

EN **Installation instructions**
FK-5 PRO Break Tank Station
Fig. 369 30 | 369 31

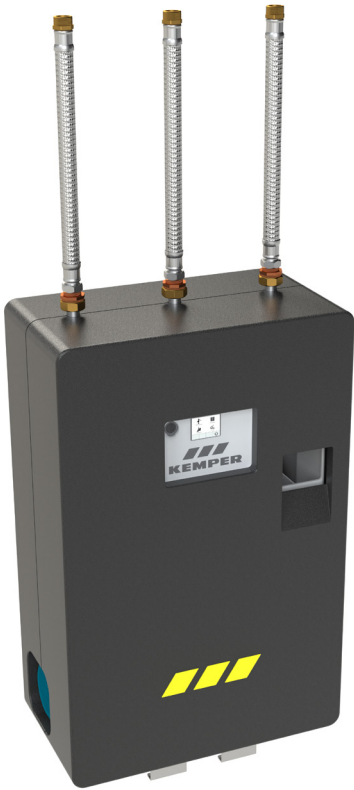

Table of content

Safety instructions	4
Scope of delivery, Versions	14
Design, function	15
Installation, Interference dimensions	16
Installation variant	17

Preparation for installation	18
------------------------------	----

FK-5 PRO installation	22
-----------------------	----

Commissioning	33
---------------	----

Connection diagram	56
--------------------	----

Installation and use

Prior to commencing installation or use read instructions carefully and follow all directions!
Pass these instructions on to the system operator and retain for later reference!

Note! If the mains connection of this device is damaged, replace it with a new connection pipe that is available from the manufacturer or its customer services.

Warning! Installation and maintenance is to be done only by competent and qualified professionals qualified for sanitary plumbing. Electrical installation is to be done only by professionals qualified for electrical facilities!

Warning! Local standard and rules for sanitary plumbing as well as accident prevention must be adhered to as a matter of priority.

Warning! Ensure sufficient bracketing, bearing capacity and statics. Select bracketing components according to wall and ground properties.

Note! The installation location must be a closed-in, dry and frost-proof room, that cannot be flooded.

Upstream and downstream of the Break Tank Station stop valves must be provided. The feed lines must be fitted with a dirt strainer or a central dirt trap strainer each of mesh size ≤ 0.6 mm (e.g. KEMPER Fig. 602).

Note! It is essential that following the installation a leak test of the water-bearing components as well as a functional test is carried out.

Danger! Disconnect the system from the mains.



Note! In sound sensitive areas, install the FK-5 only on floor stands and not on a wall to minimize vibration sound transmission. Use flexible hoses to connect the supply lines.

Warning information

Please read and follow the warning information in these instructions. Disregard of the warning information may lead to injury or material damage!

Labelling of important warning information:



Danger! Electricity!

Indicates hazards that might result in severe or fatal injury.



Warning! Indicates hazards that may lead to injury, material damage or contamination of drinking water.



Note! Indicates hazards that may lead to damages to the system or malfunctions.

Intended use

The KEMPER FK-5 Break Tank Station is used for separating potable from non-potable water installations if fluid category 5 according to DIN EN 1717 / DIN 1988-100.

The device must only be operated with water.
Do not fill with flammable or explosive media.

Warning! The product must only be used for this purpose as Break Tank Station in enclosed, frost-free, dry rooms. Any other use is considered contrary to the designated use.

Warning! Disregard of instructions during installation, use or maintenance can impair proper operation and can cause considerable health problems due to the mixture of drinking and non-potable water.

**Note!**

Service hotline for the areas of commissioning and maintenance

Tel.: +49 2761 891-888

E-mail: servicegt@kemper-group.com.

After-sales service

Service hotline

Tel.: +49 2761 891 800

E-mail: anwendungstechnik@kemper-group.com



Safety instructions for installation, maintenance and operation



Warning! Always connect an expansion vessel PN10 with min. 33 liter to the pressurized secondary outgoing pipe. The pre-charge pressure of the expansion vessel must always be 0.5 bar below the cut-in pressure of the FK-5.

Important notes for the system plumber

Power supply	230 V AC
Electrical power input	5,9 A
Electrical power	1350 W
Power factor	0,98
Protection class	IPX4
Medium	Water
Ambient temp., max.	40°C
Ambient temp., min.	2°C
Inflowing medium, temp. max.	35°C
Inflowing medium, temp. min.	2°C
Flow pressure, max.	2x Inlet: 0,4 MPa
Flow pressure, min	2x Inlet: 0,15 MPa
Pressure stage	PN 10
Outlet pump pressure	0,47 MPa
DU value	2x Inlet: 1,67 l/s
Flush volume of PWC line (at 3 bar)	1,5 bar flow pressure 5,5l/min 2,5 bar flow pressure 14 l/min 4,0 bar flow pressure 18 l/min

1. Only use the device
 - in sound condition
 - as intended
2. It is essential that the specified maintenance intervals are kept.



Warning! Under no circumstances must any water drawn be used as drinking water - even in small amounts!

Warning! Following the installation, addition of accessories or maintenance, all feed lines must be flushed according to DIN EN 806-5 and VDI/DVGW (Association of German Engineers/ German association for gas and water) 6023.

Note! According to DIN EN 13077 it is prohibited to close the emergency overflow on the receiver tank.

Liability

No warranty or liability will be accepted in case of:

- Non-compliance with the instructions.
- Incorrect installation and/or operation.
- Unauthorised modification of the product.
- Other incorrect operation.



Disposal

Local regulations on waste recycling and disposal must be followed.

The product must not be disposed of with household waste but must rather be disposed of in accordance with local regulations.

Manufacturer's note (GH/UP – review):

If there is a risk that the room in which the safety device is to be installed is at risk of flooding according to the definition of DIN EN 1717, No. 3.2.2, the safety device must be installed in a higher room in the building.

If this is not possible, further measures must be taken in consultation with the designer, installer or operator that ensure that the total volume flow (normally: amount of discharged water and in the event of a malfunction: volume of water at maximum volume flow of a safety device) can be accepted and safely drained away by a drainage device or a drainage system.

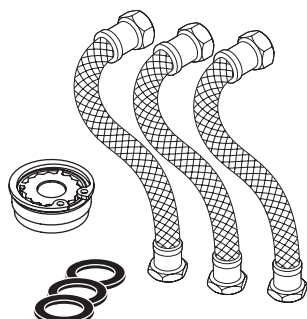
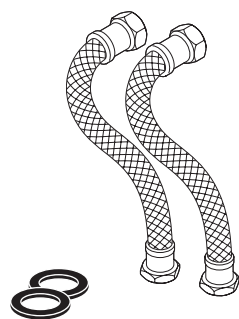
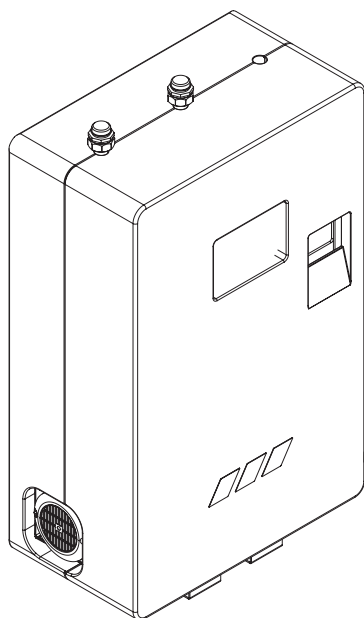
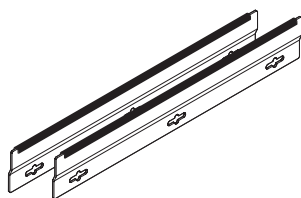

		Art.-No.
GB	Typ: G	<div><div>A</div>= 3693402500</div> <div><div>B</div>= 3693502500</div>



DIN EN 806-5
DIN 1986-100
DIN EN 12056

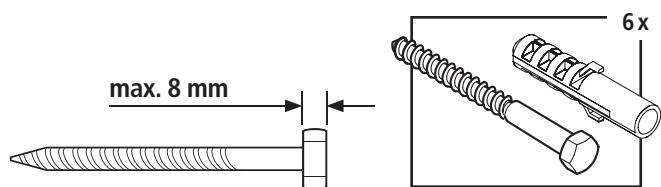

Pos.	Art.-No.
------	----------

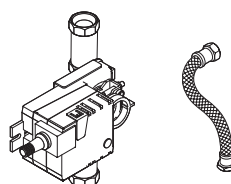

36951025000

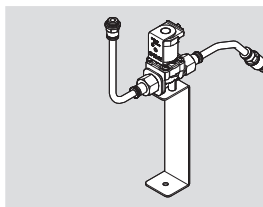

3690200100

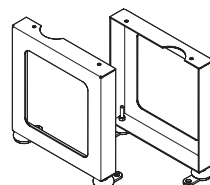

3690300100

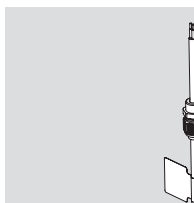

3690400100

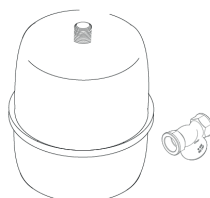

3695700100



DVGW



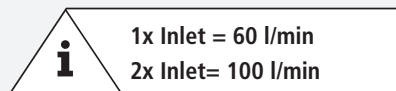
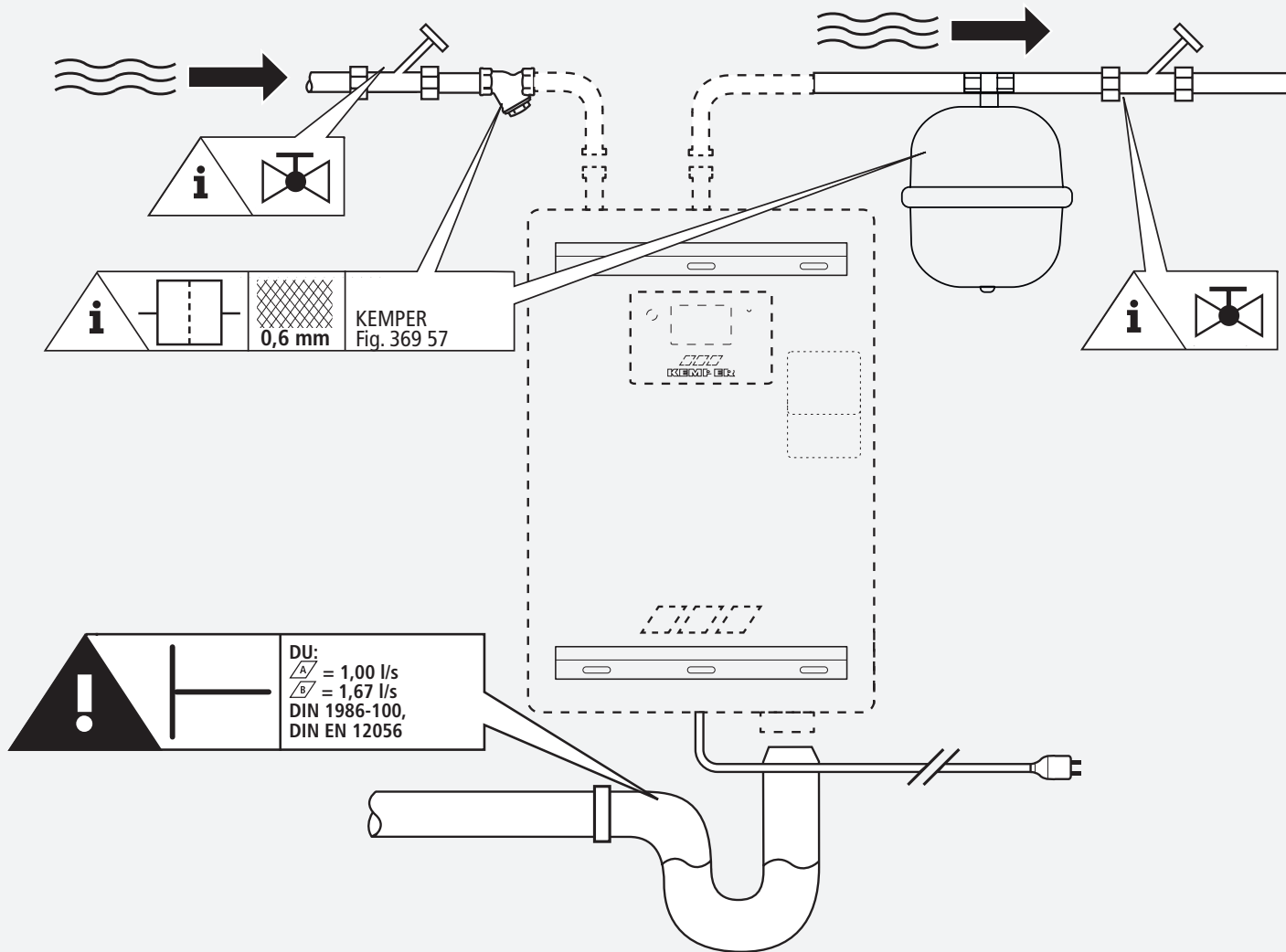
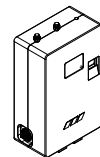

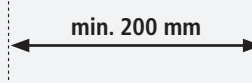
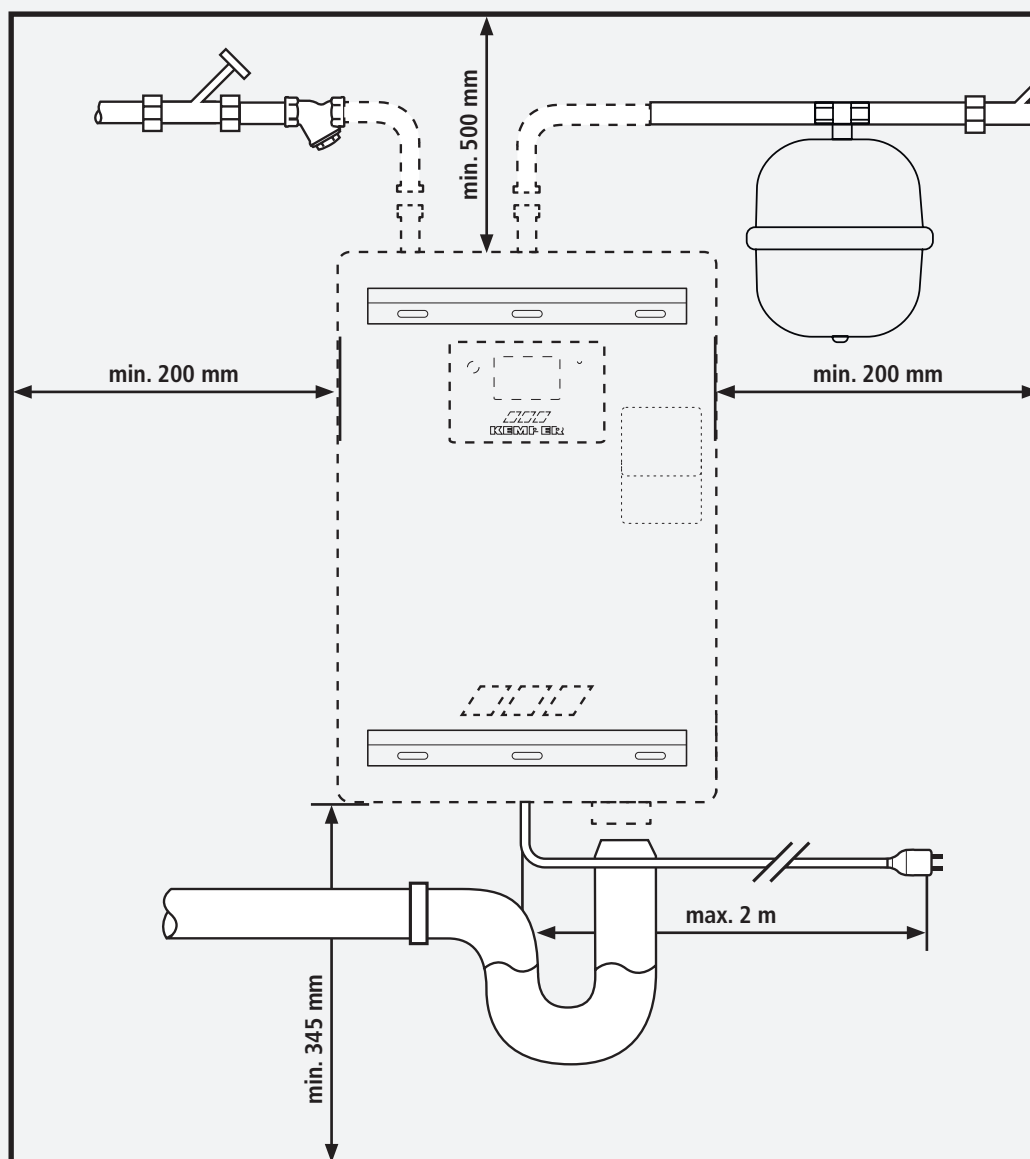
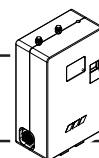

i

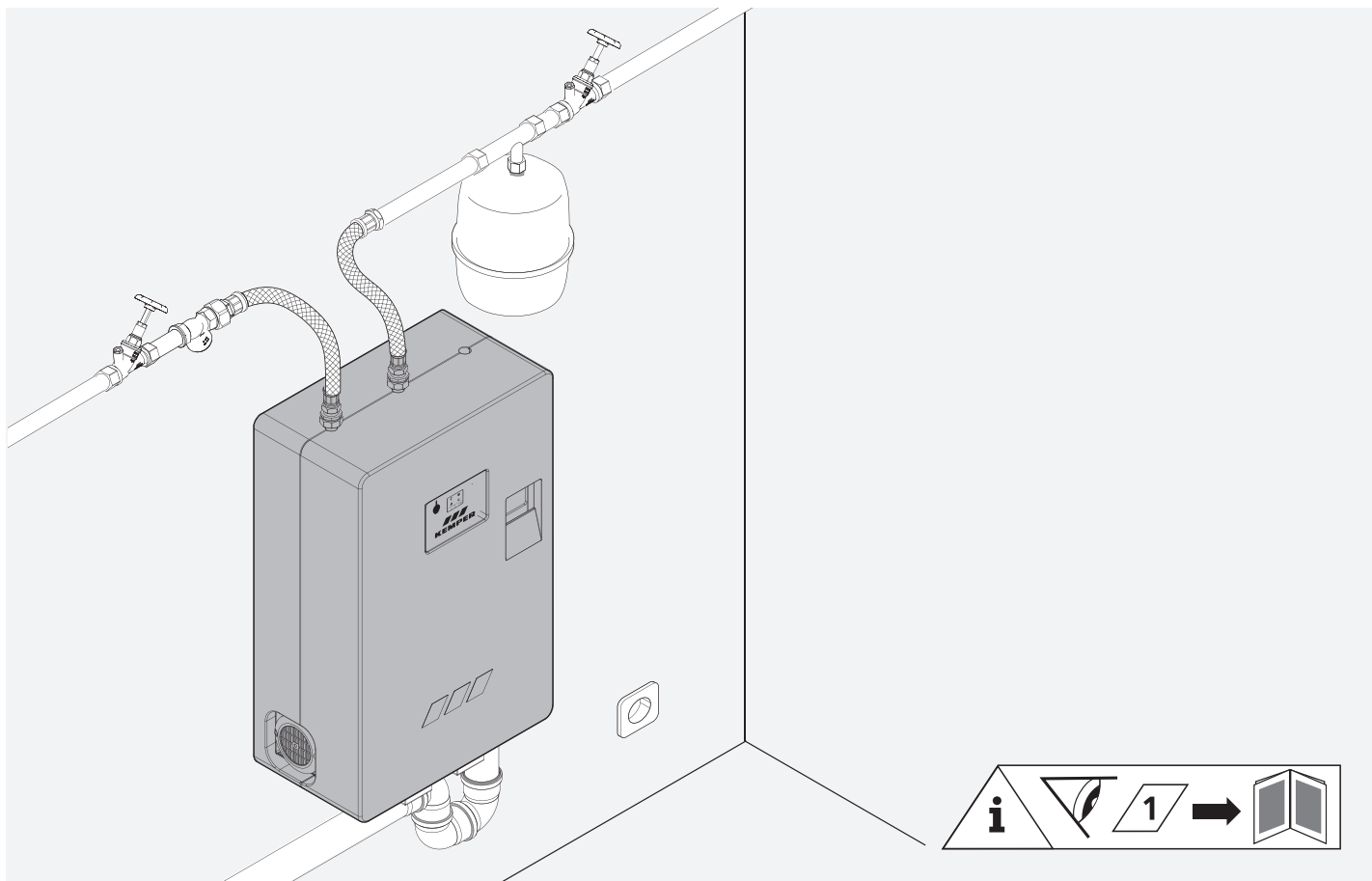
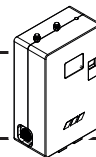

+

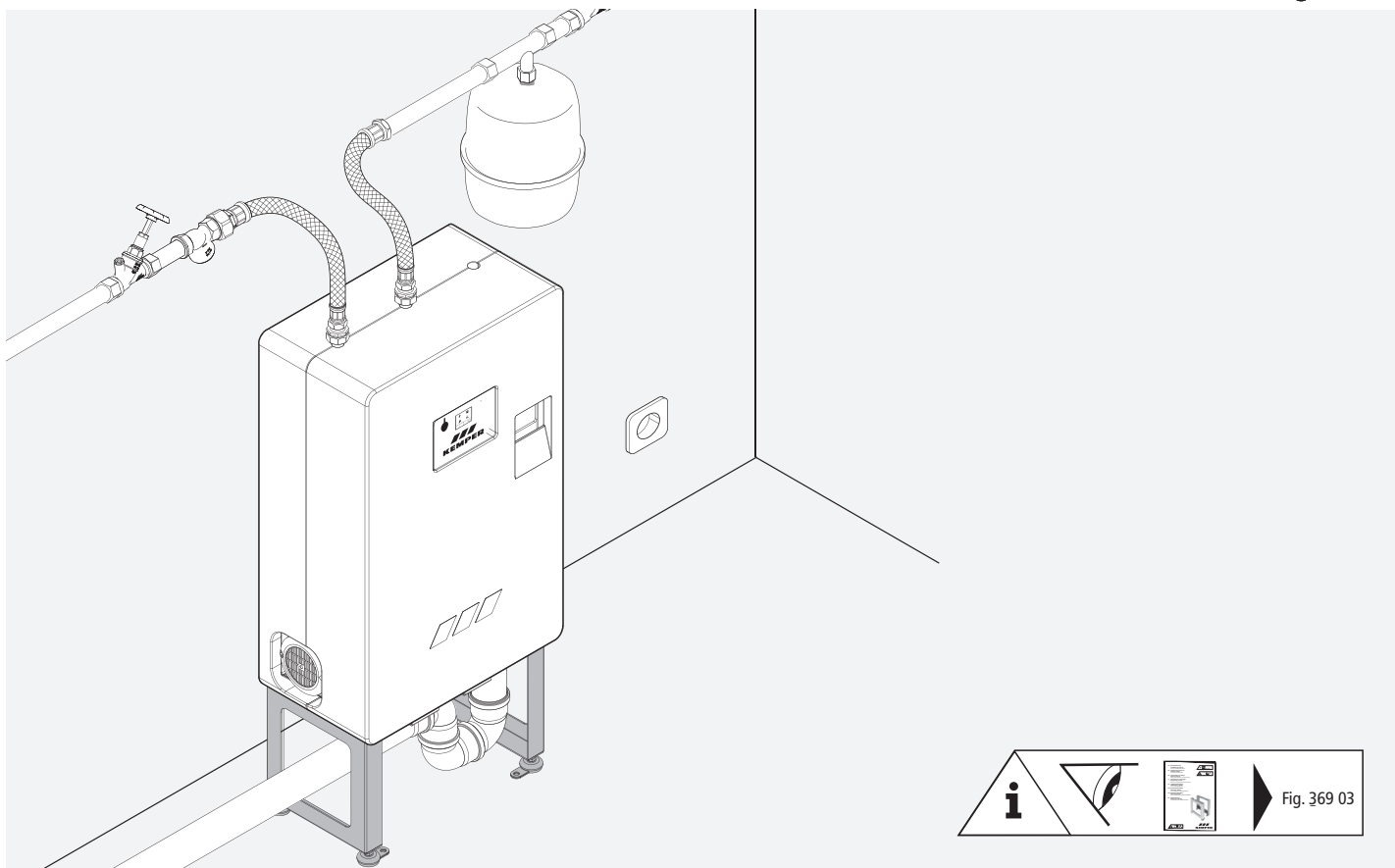
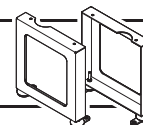

1

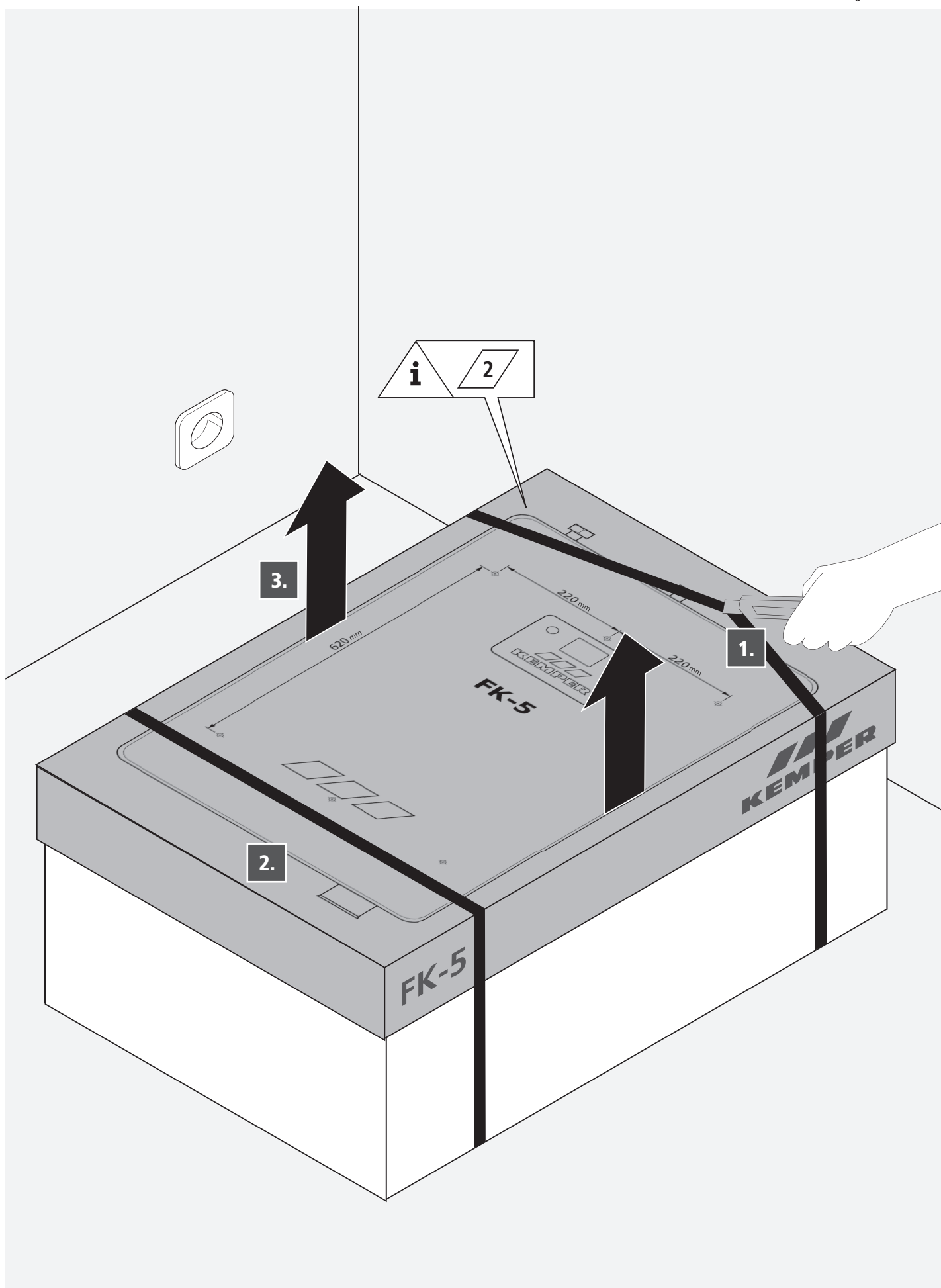
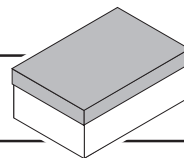



1.



i

KG 45,5 kg / 47,7 kg

4.

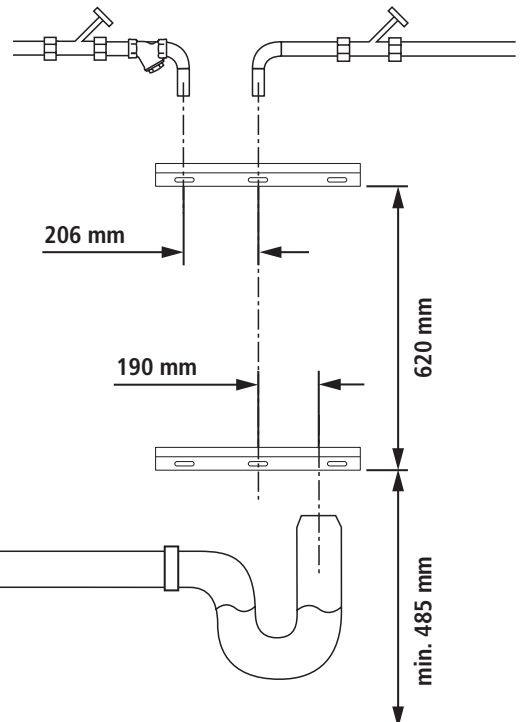
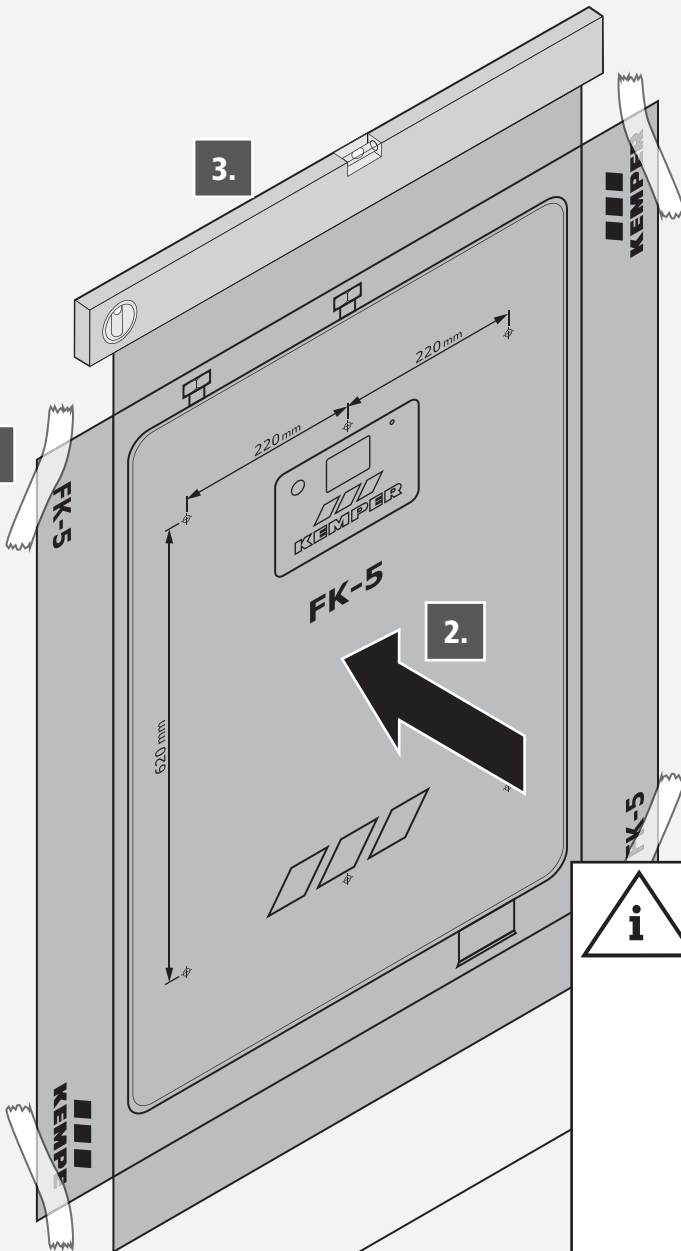

3

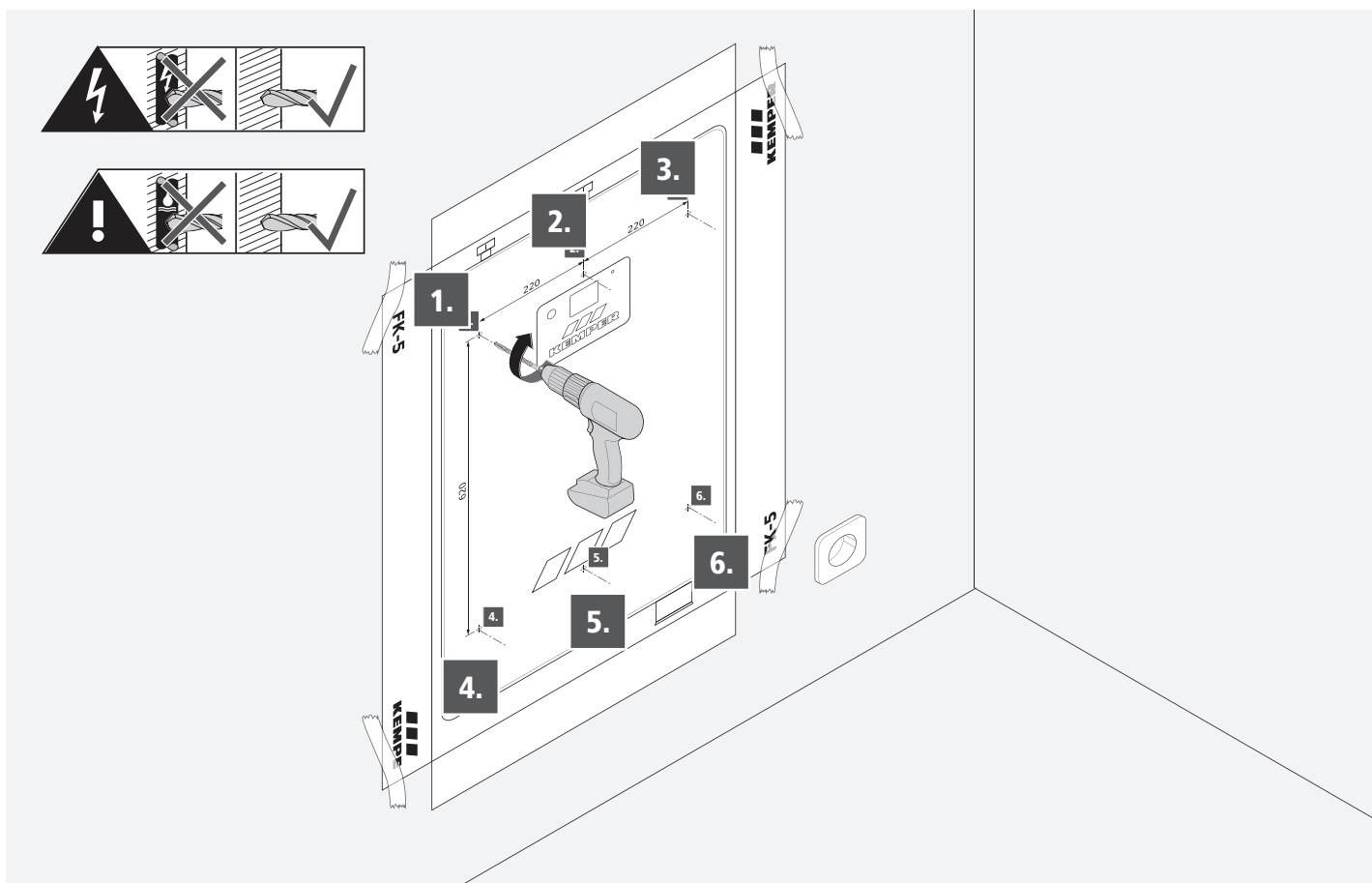
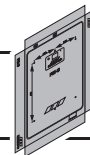

4

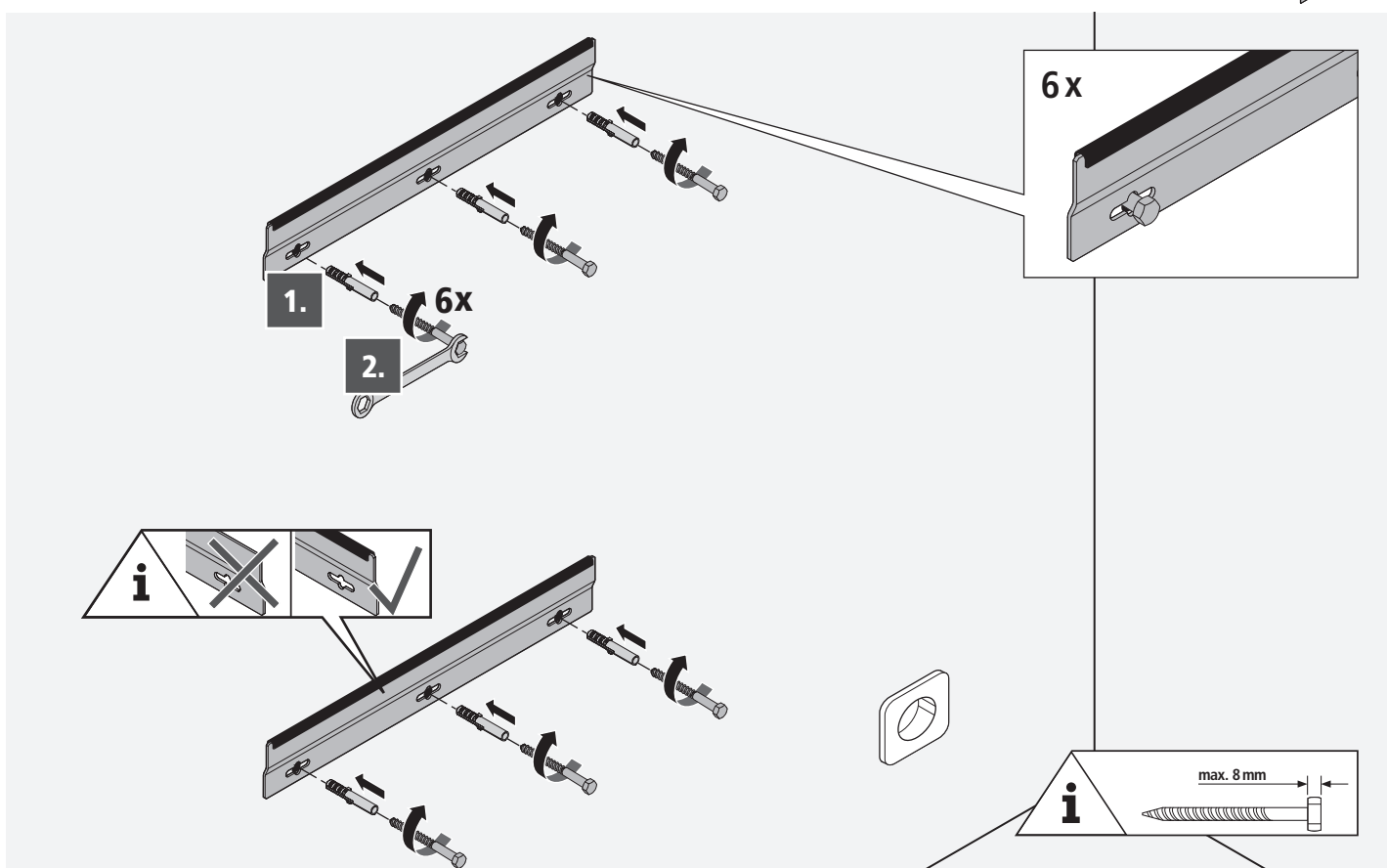

5

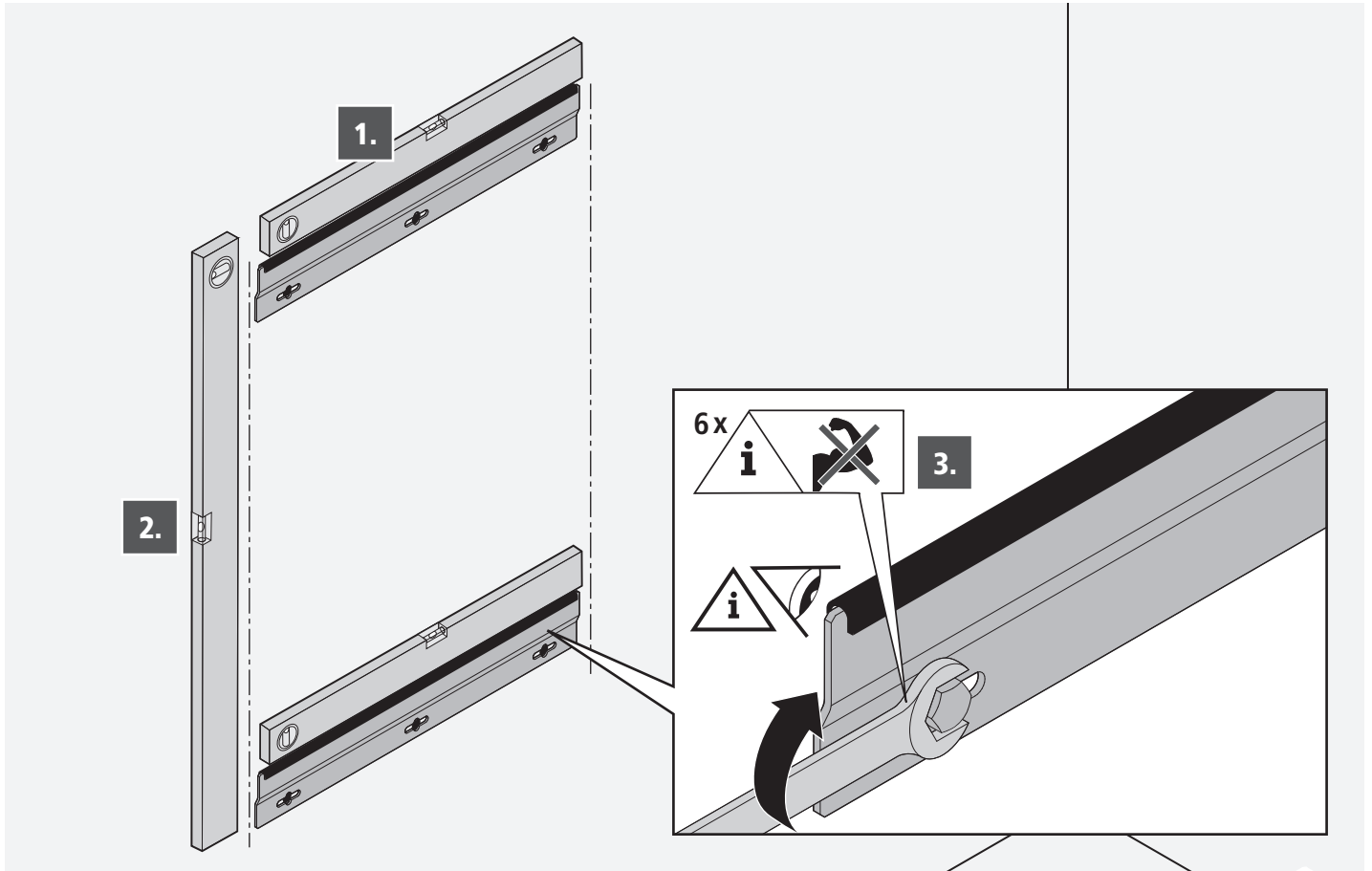

6

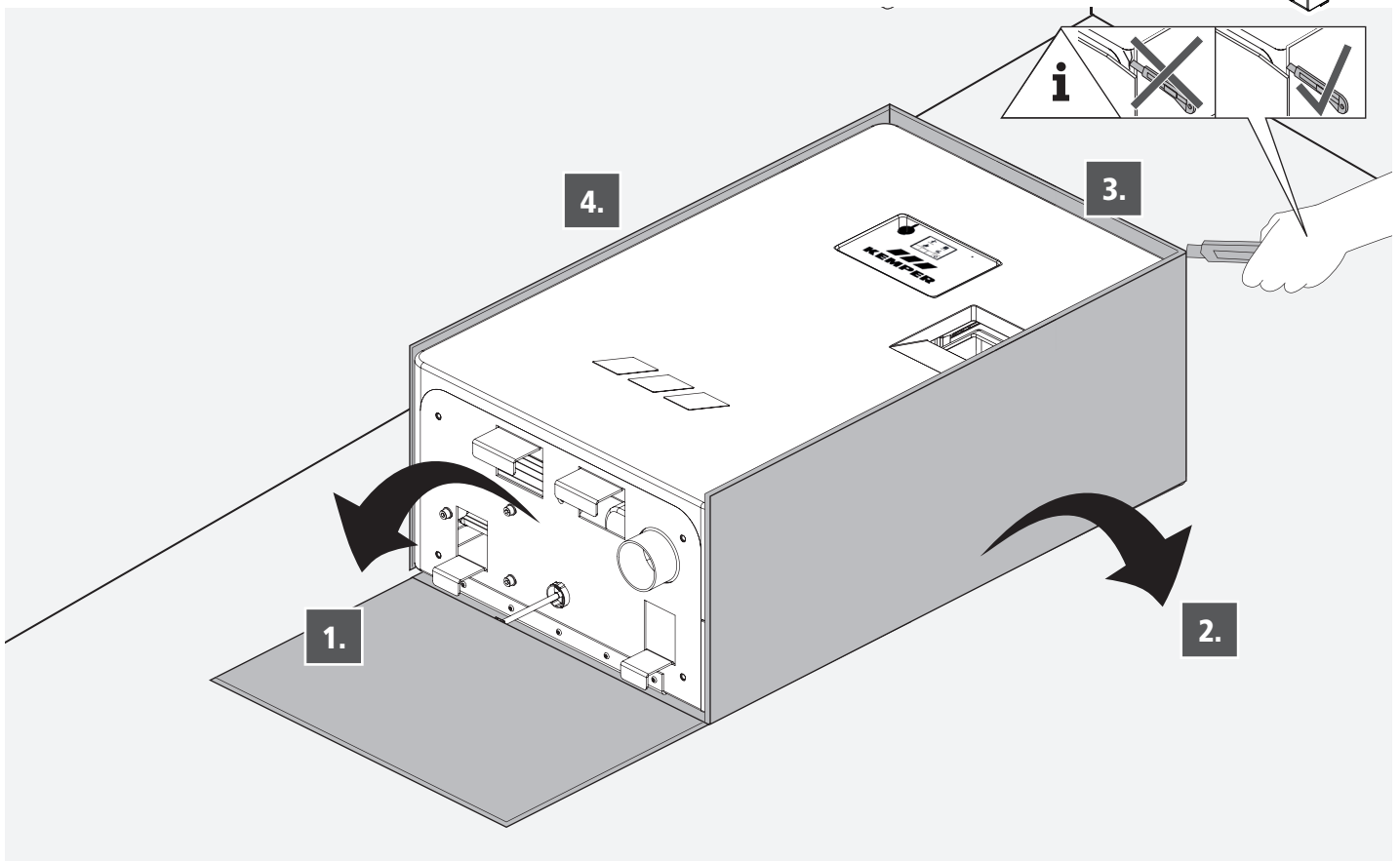

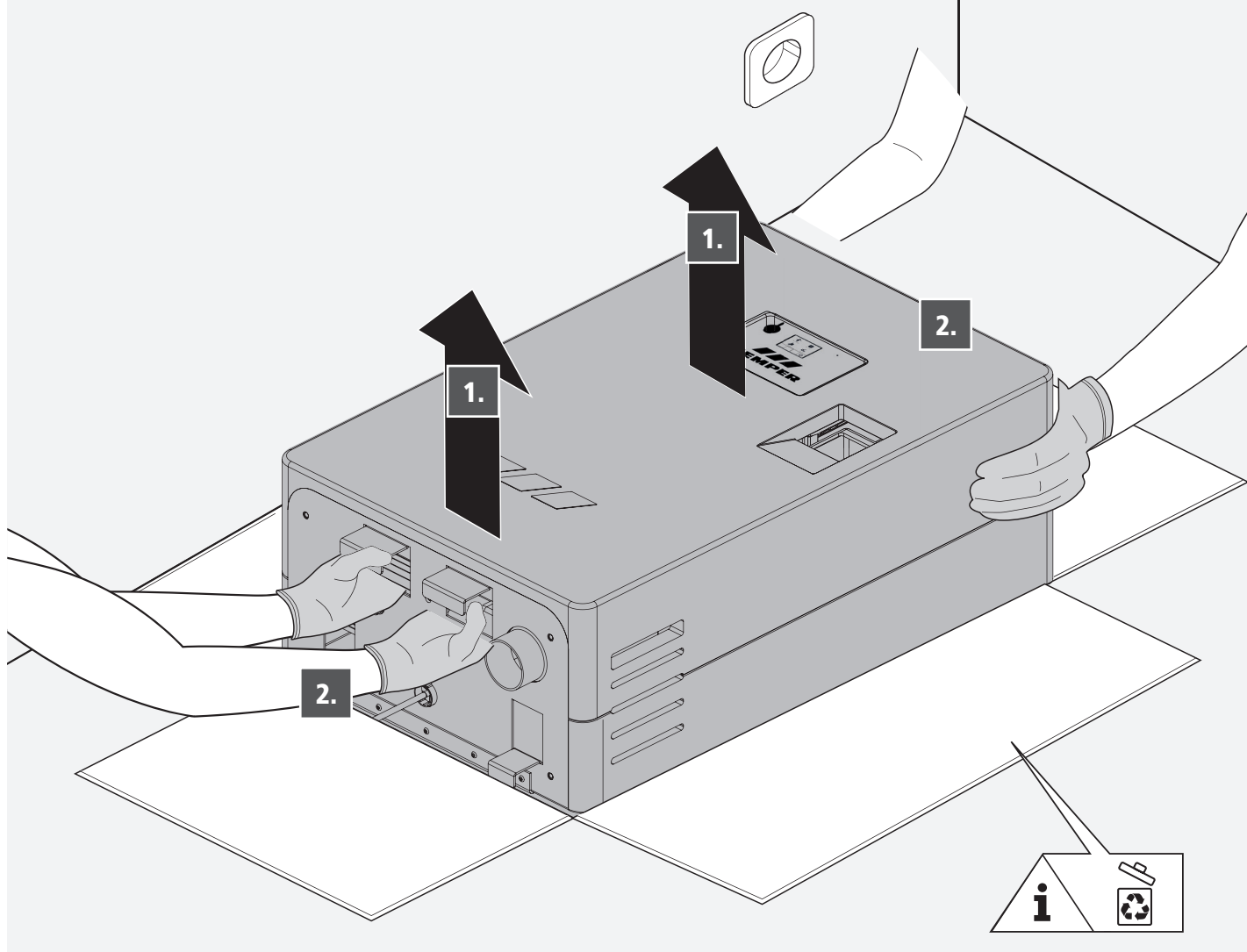
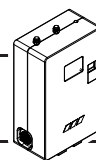

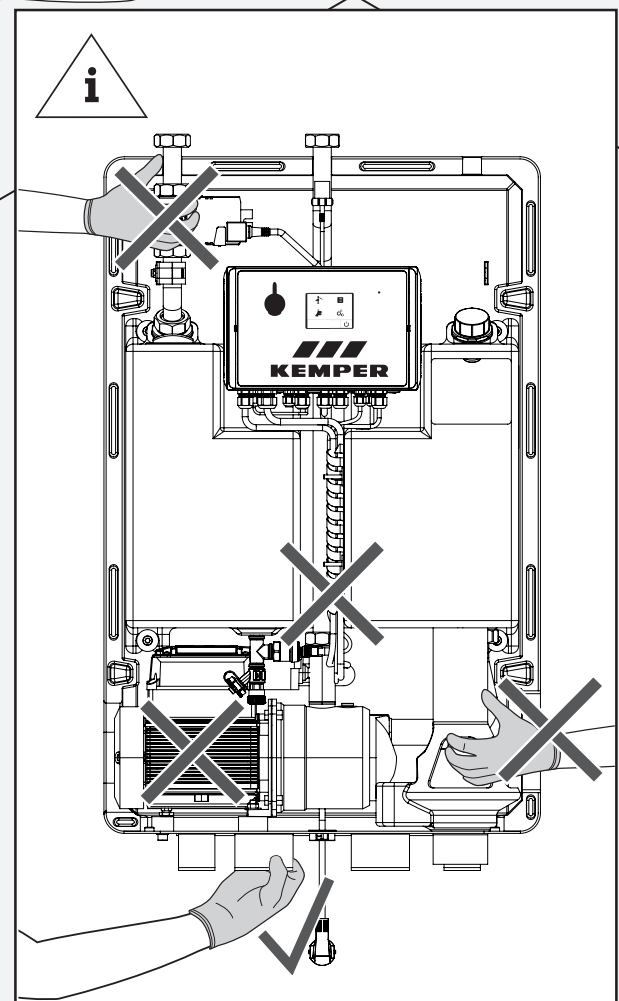
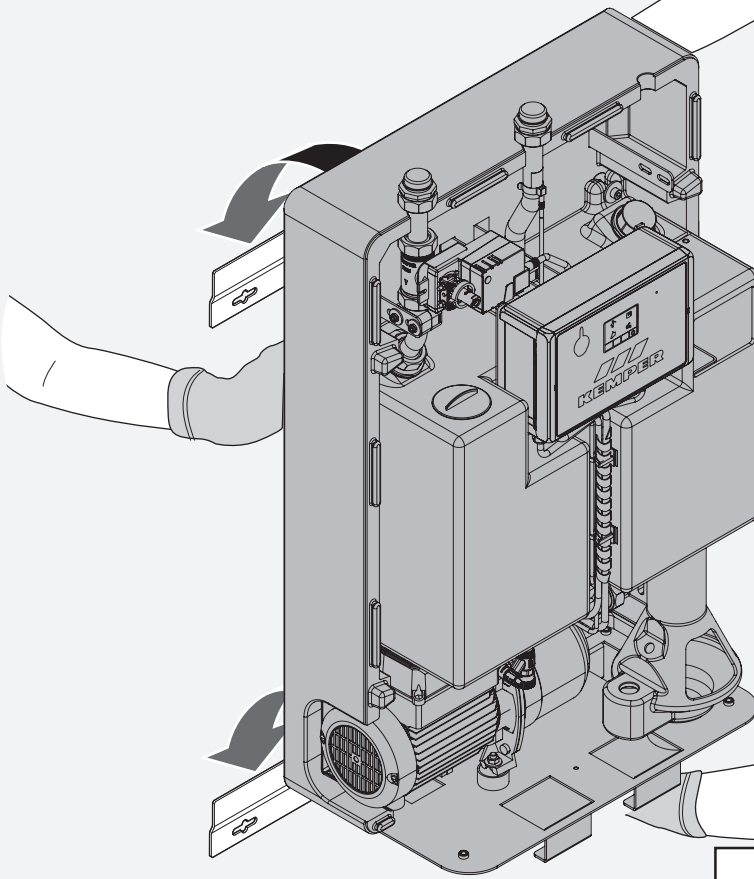
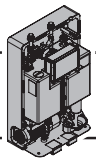

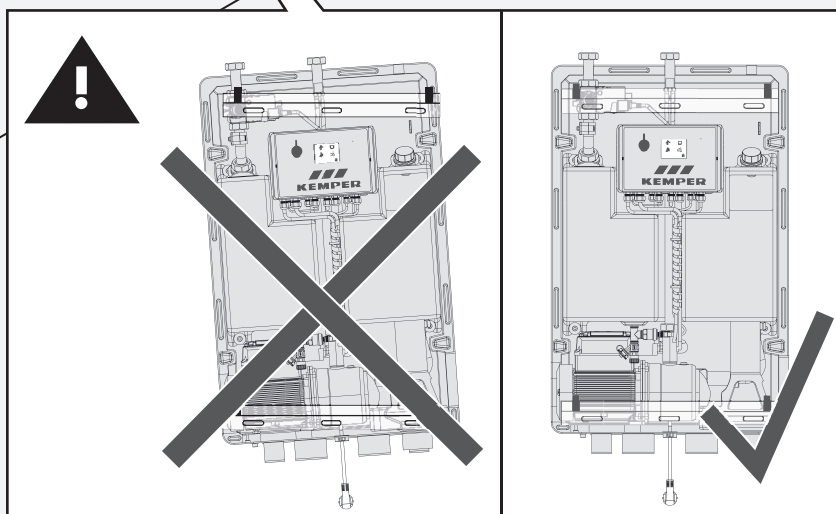
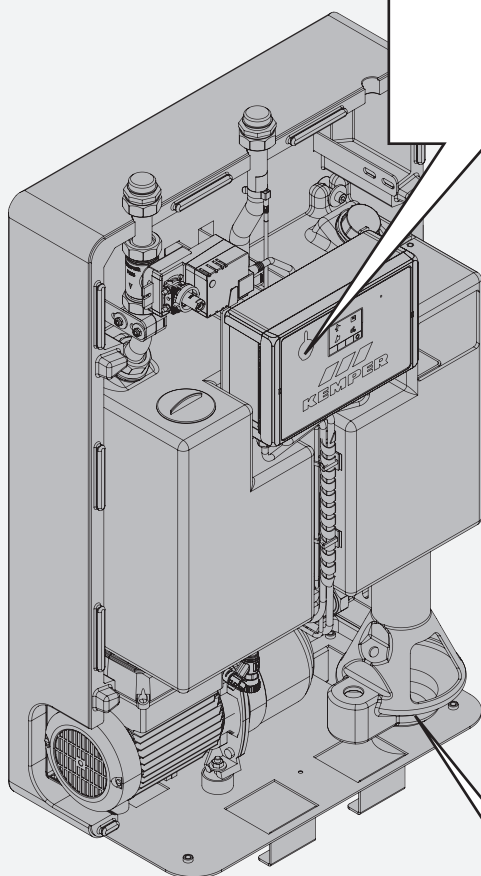
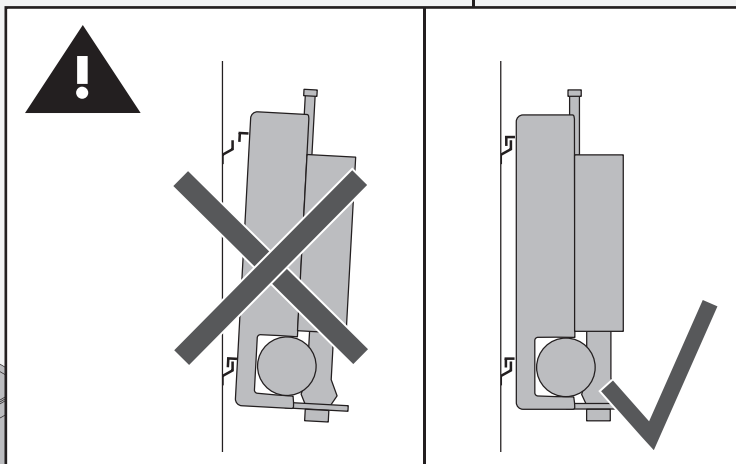
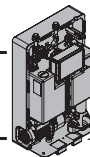

10

A

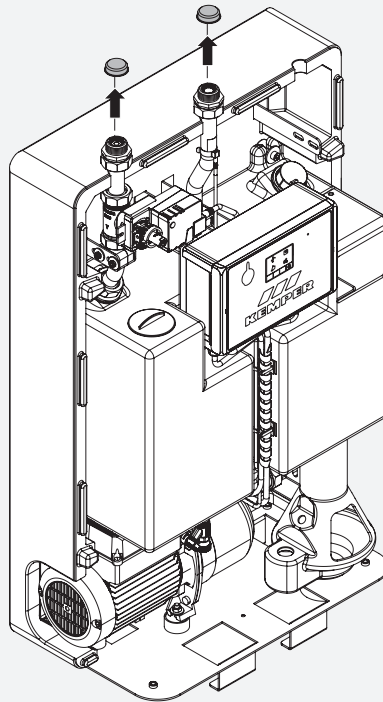
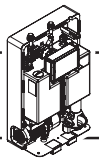

10

B

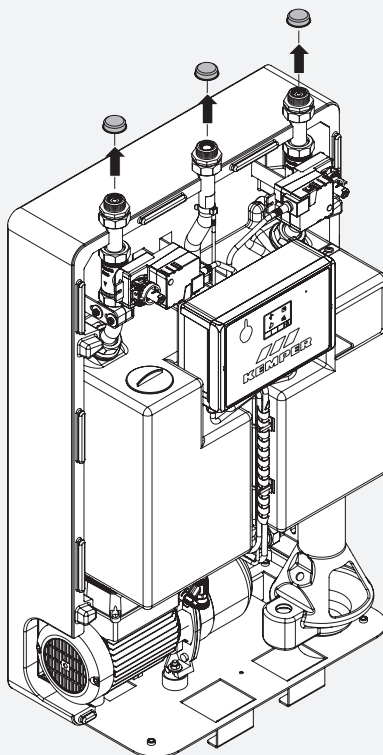
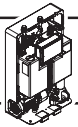

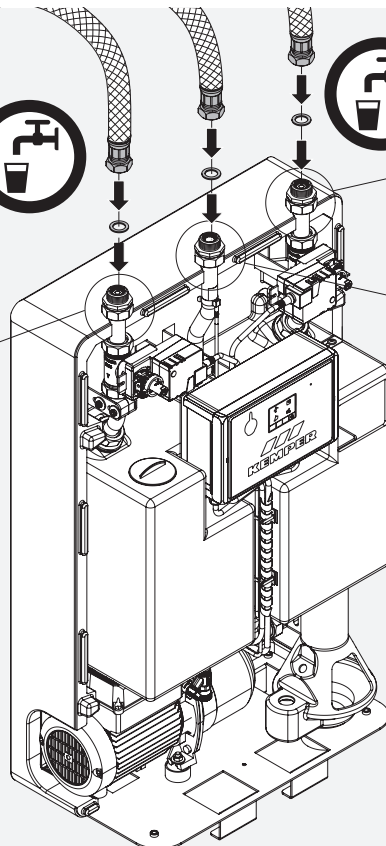
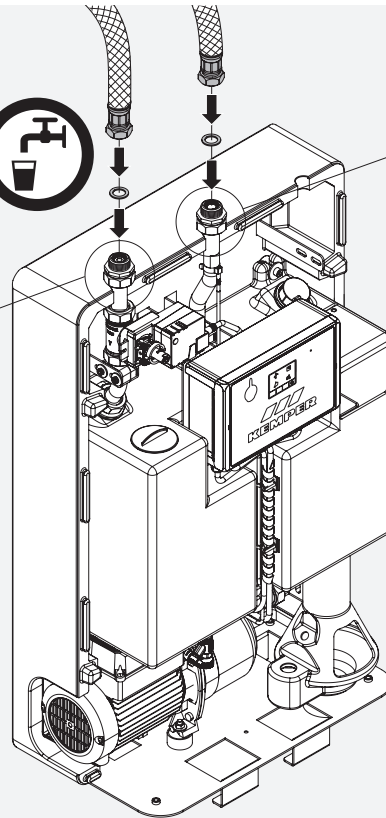

1

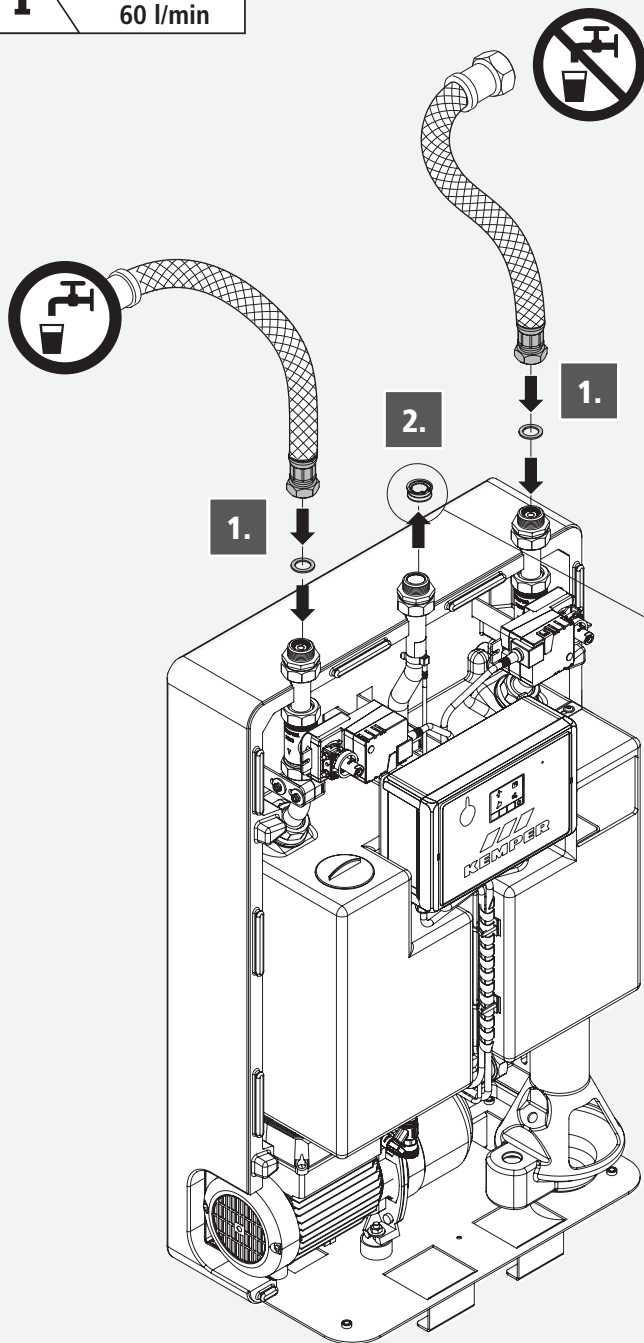

DMB white



YouTube



2

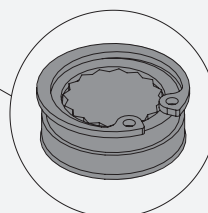
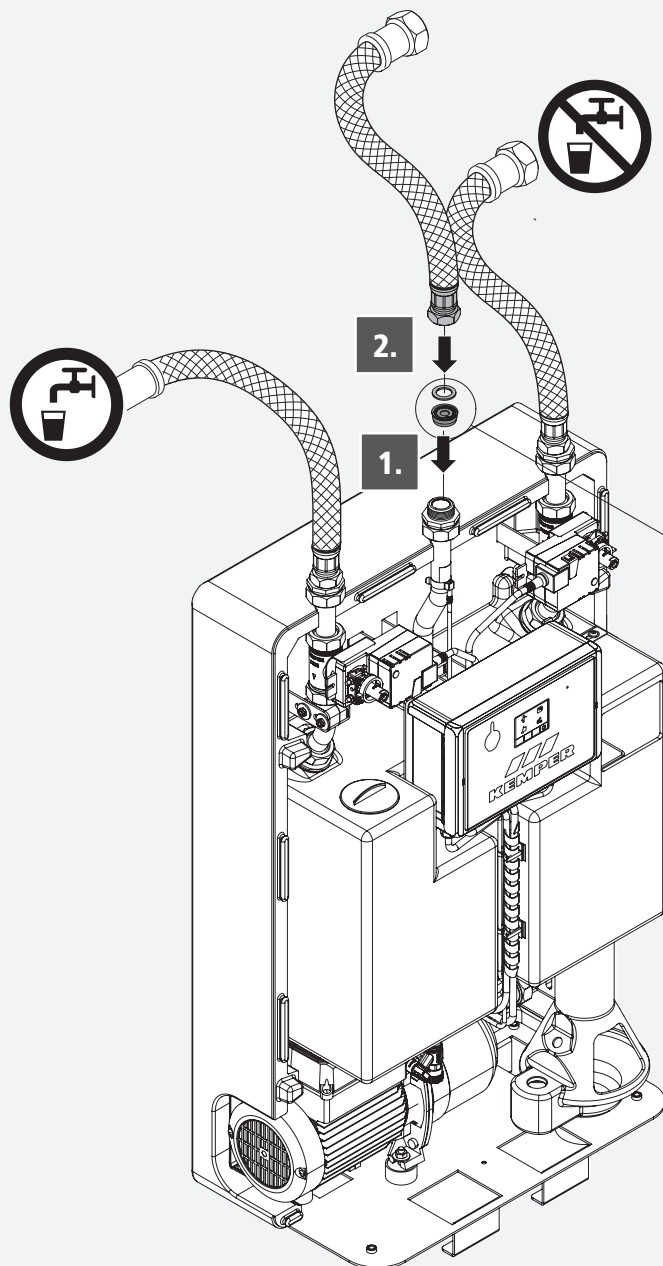

DMB blue



YouTube

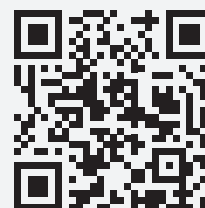

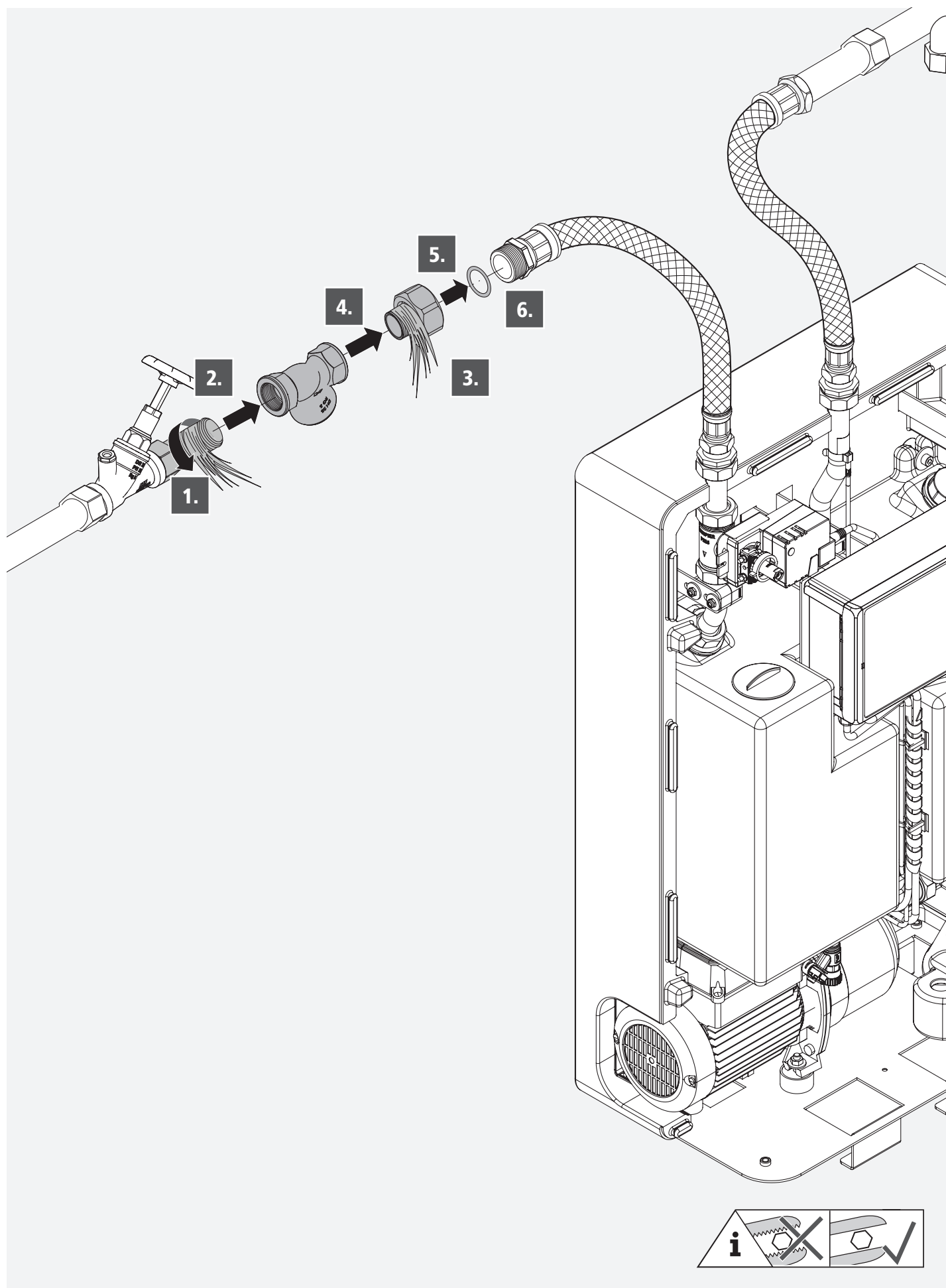
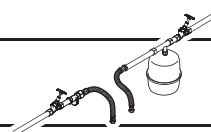

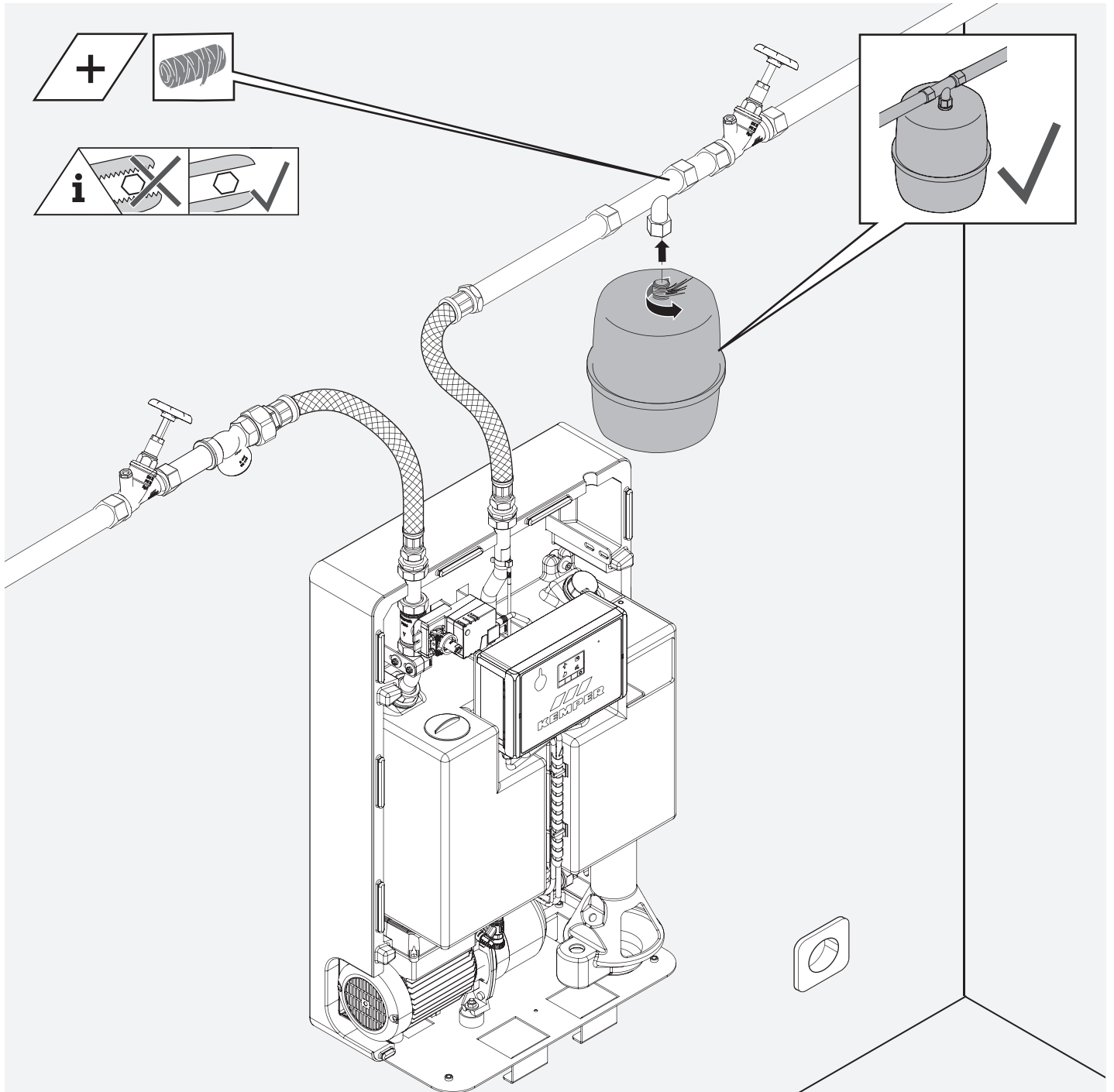
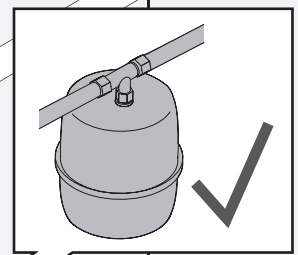
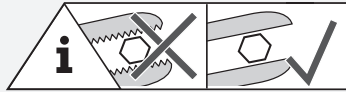
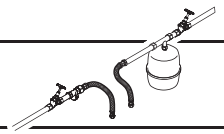

Warning! Always connect an expansion vessel PN10 with min. 33 liter to the pressurized secondary outgoing pipe. The precharge pressure of the expansion vessel must always be 0.5 bar below the cut-in pressure of the FK-5.

14

A

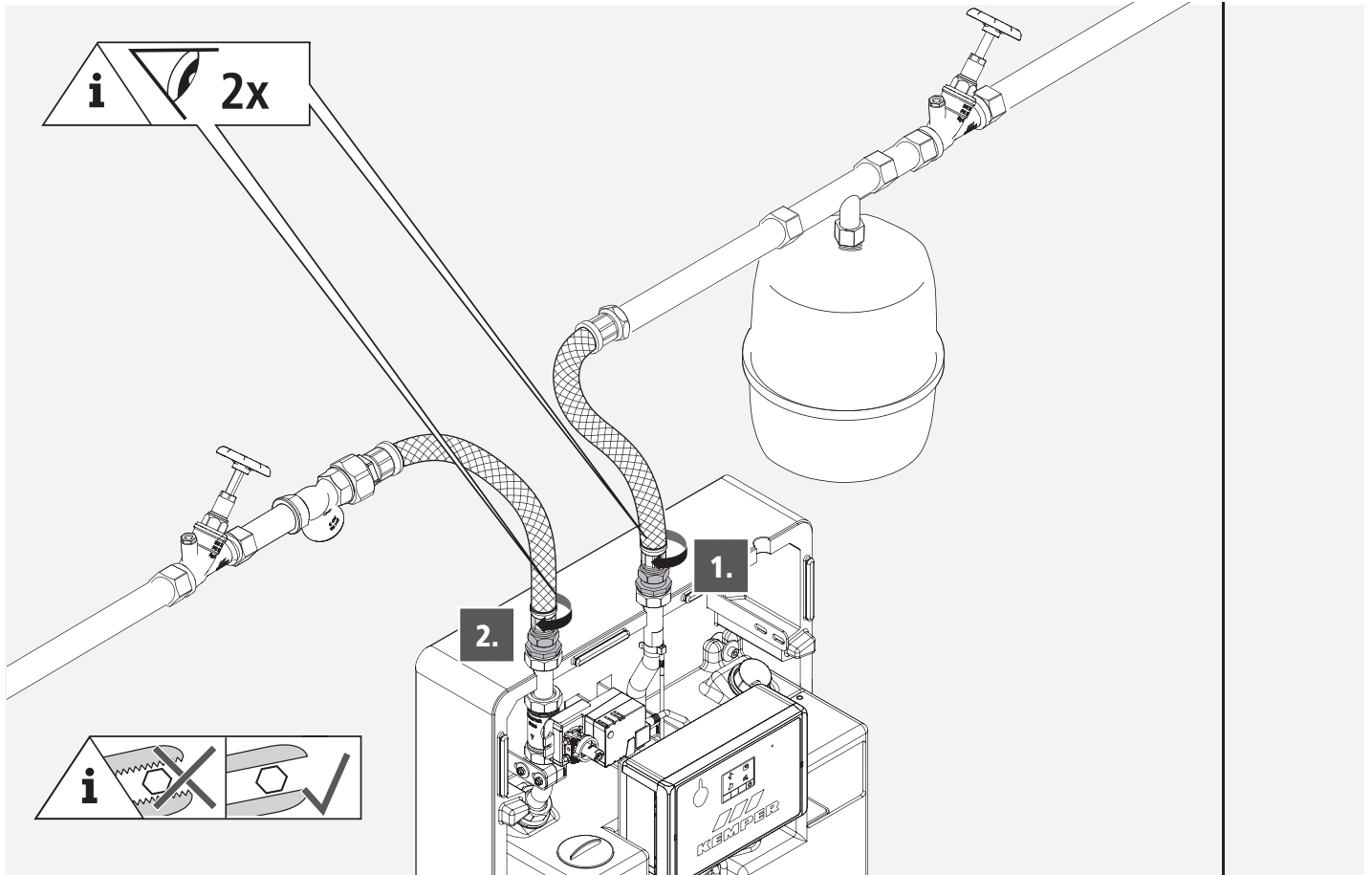

14

B

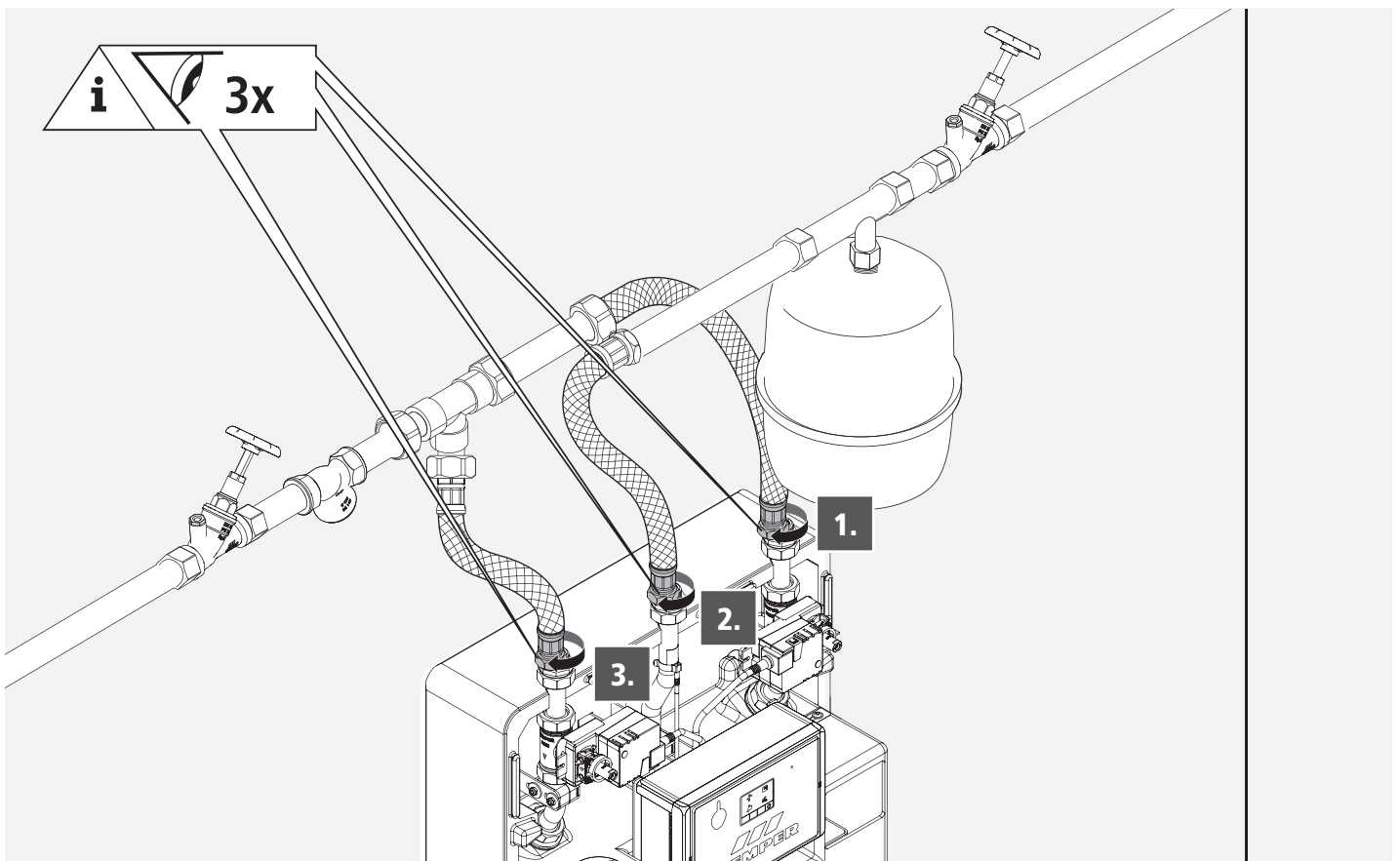

15

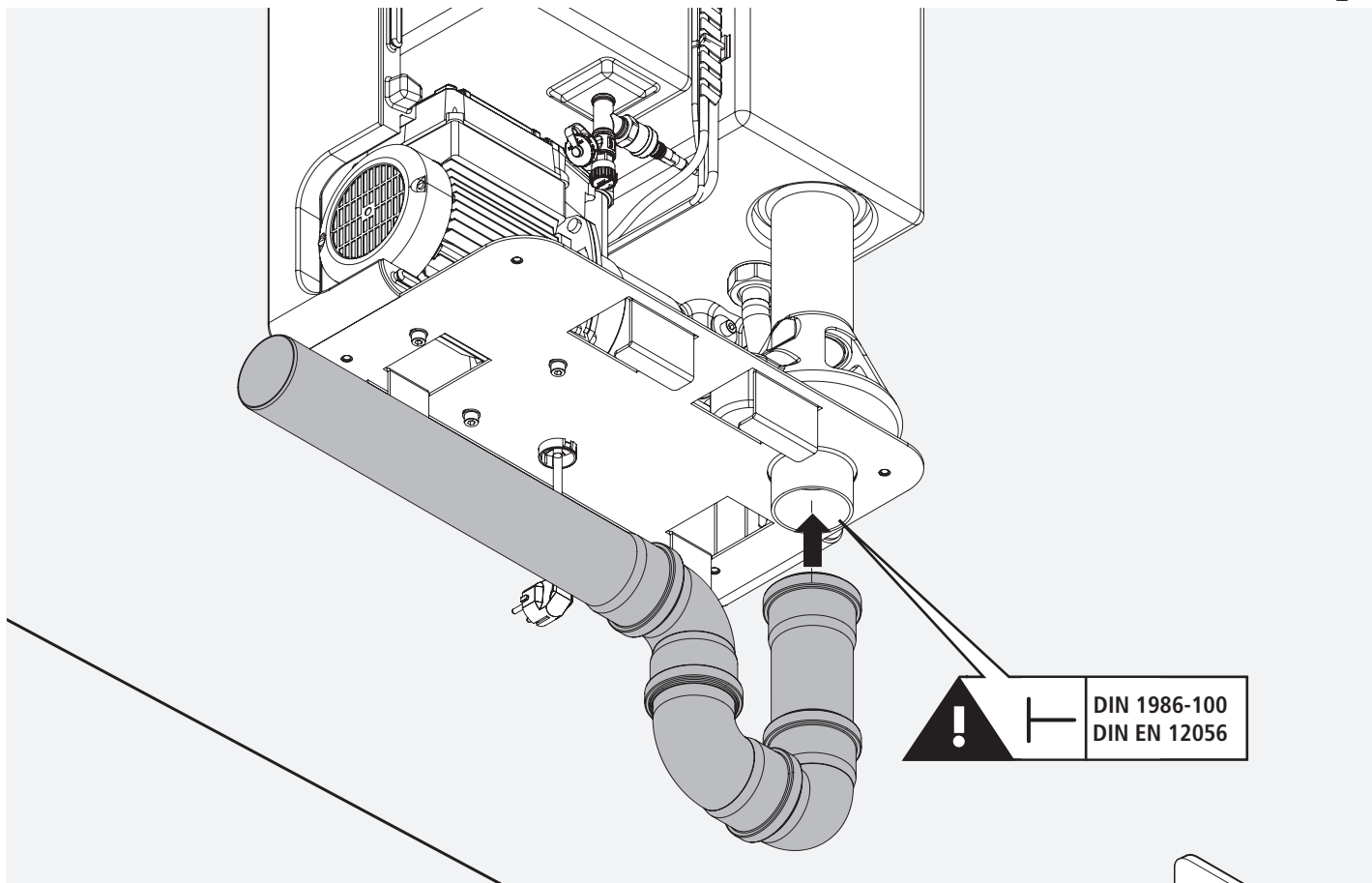

16

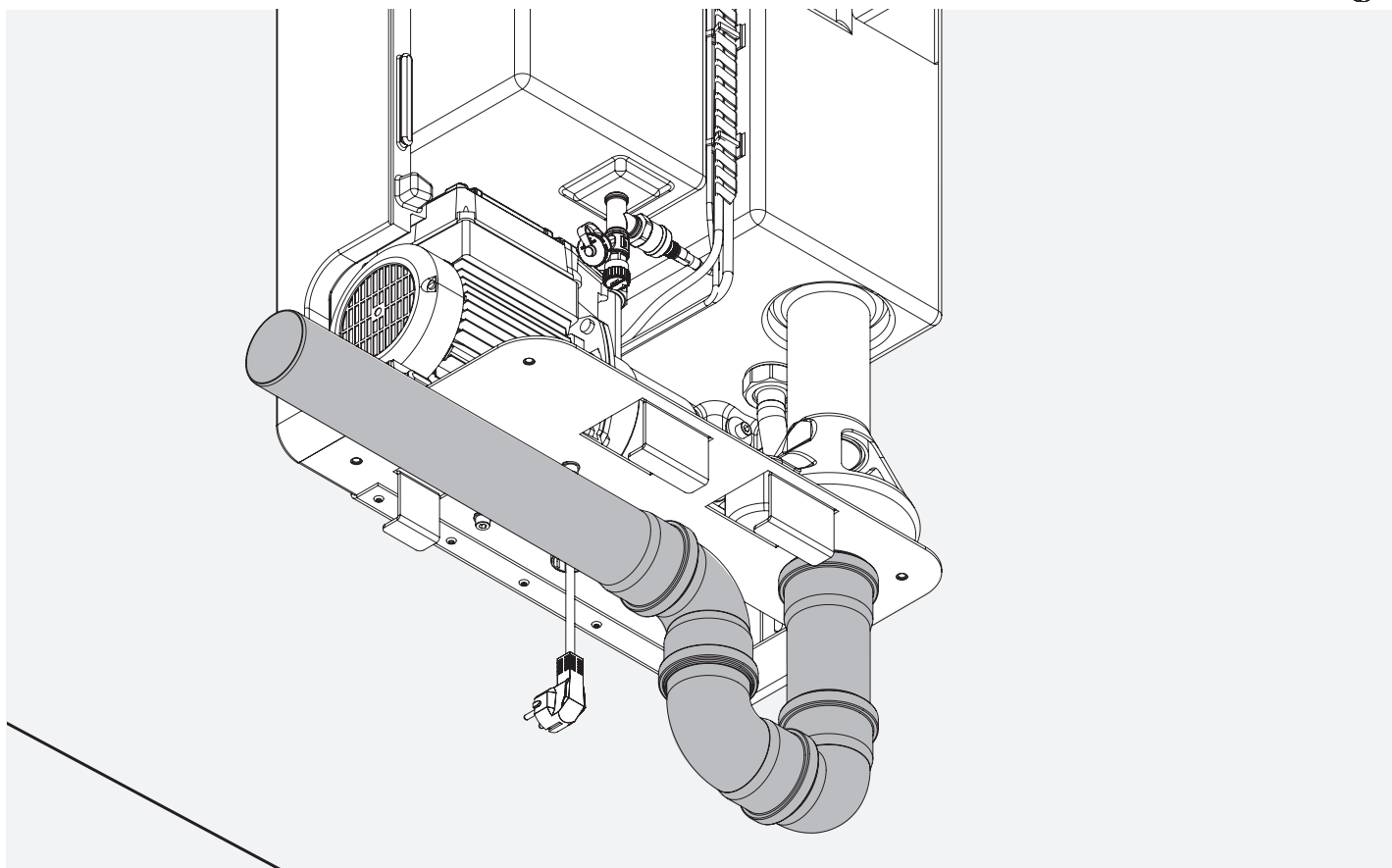

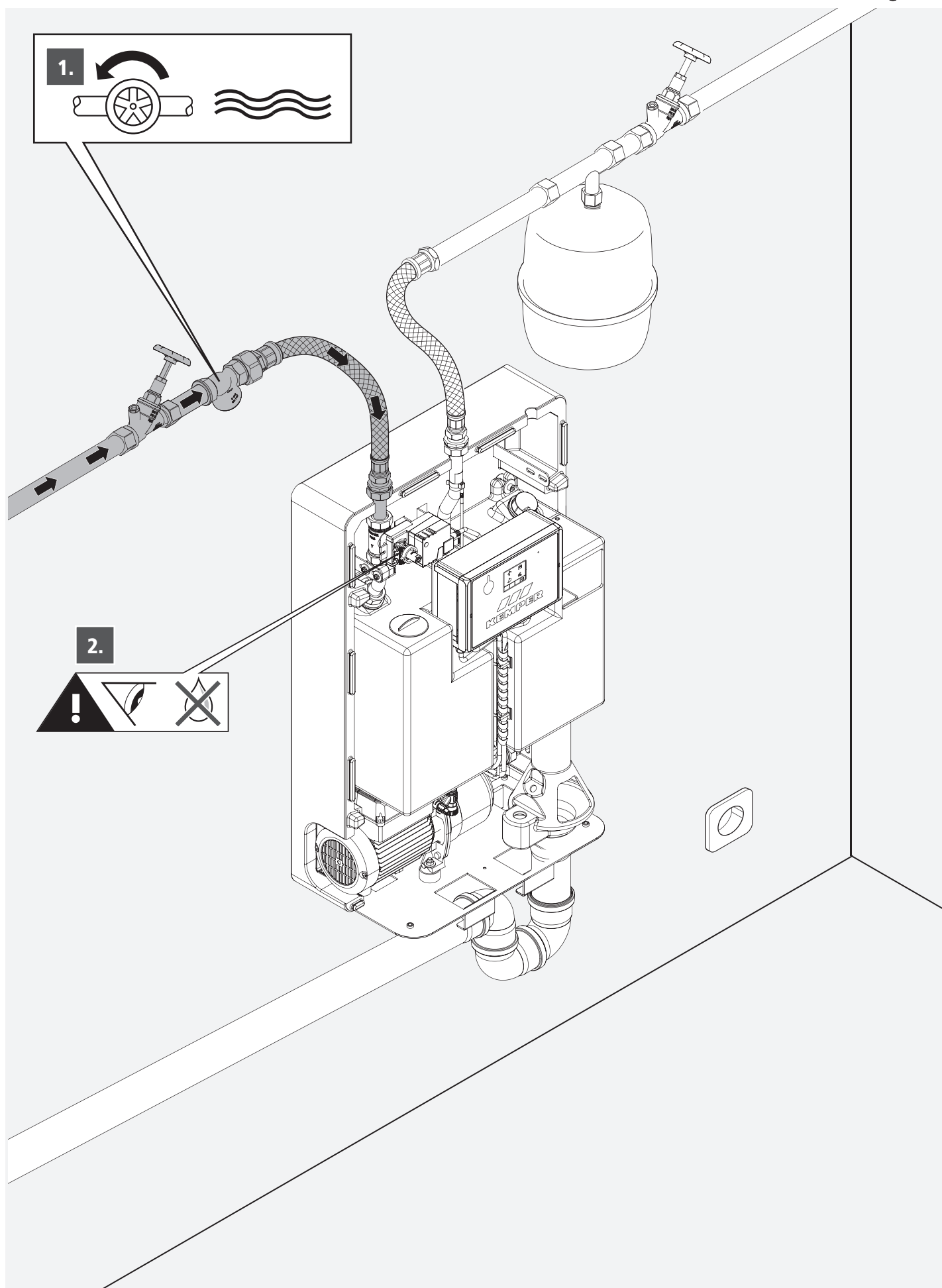
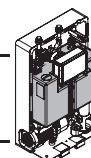

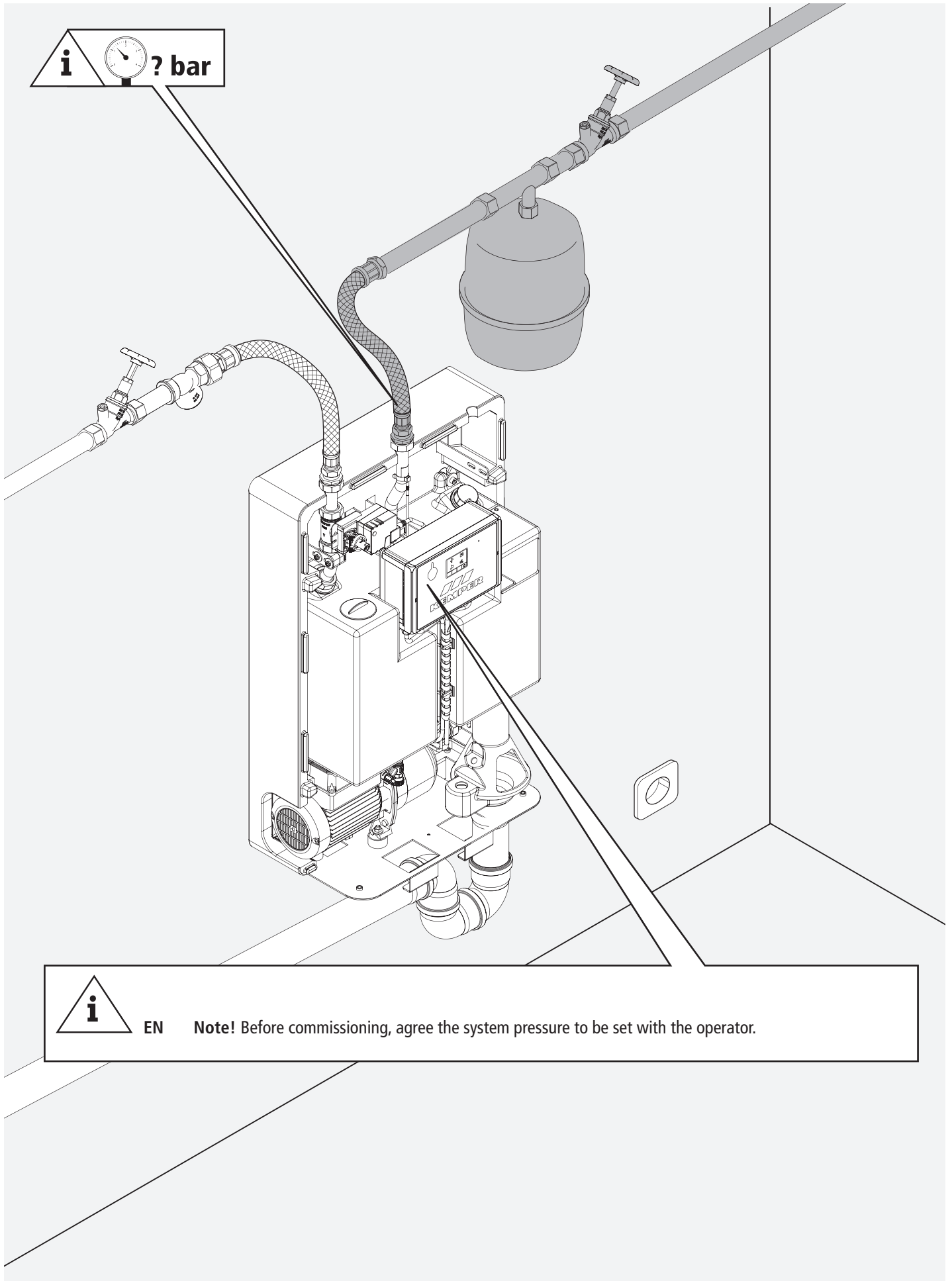
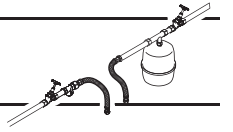

EN

Note! Before commissioning, agree the system pressure to be set with the operator.

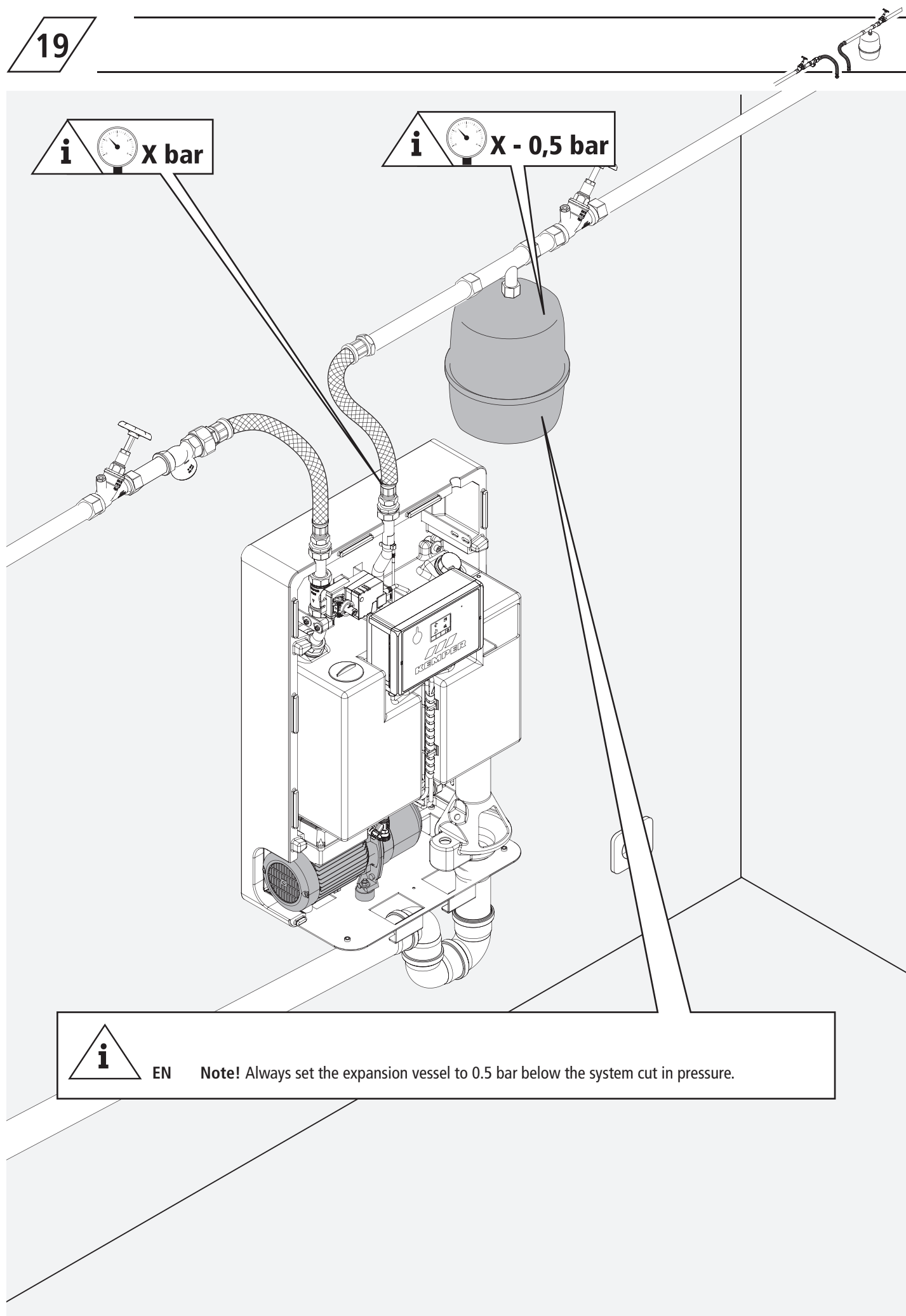

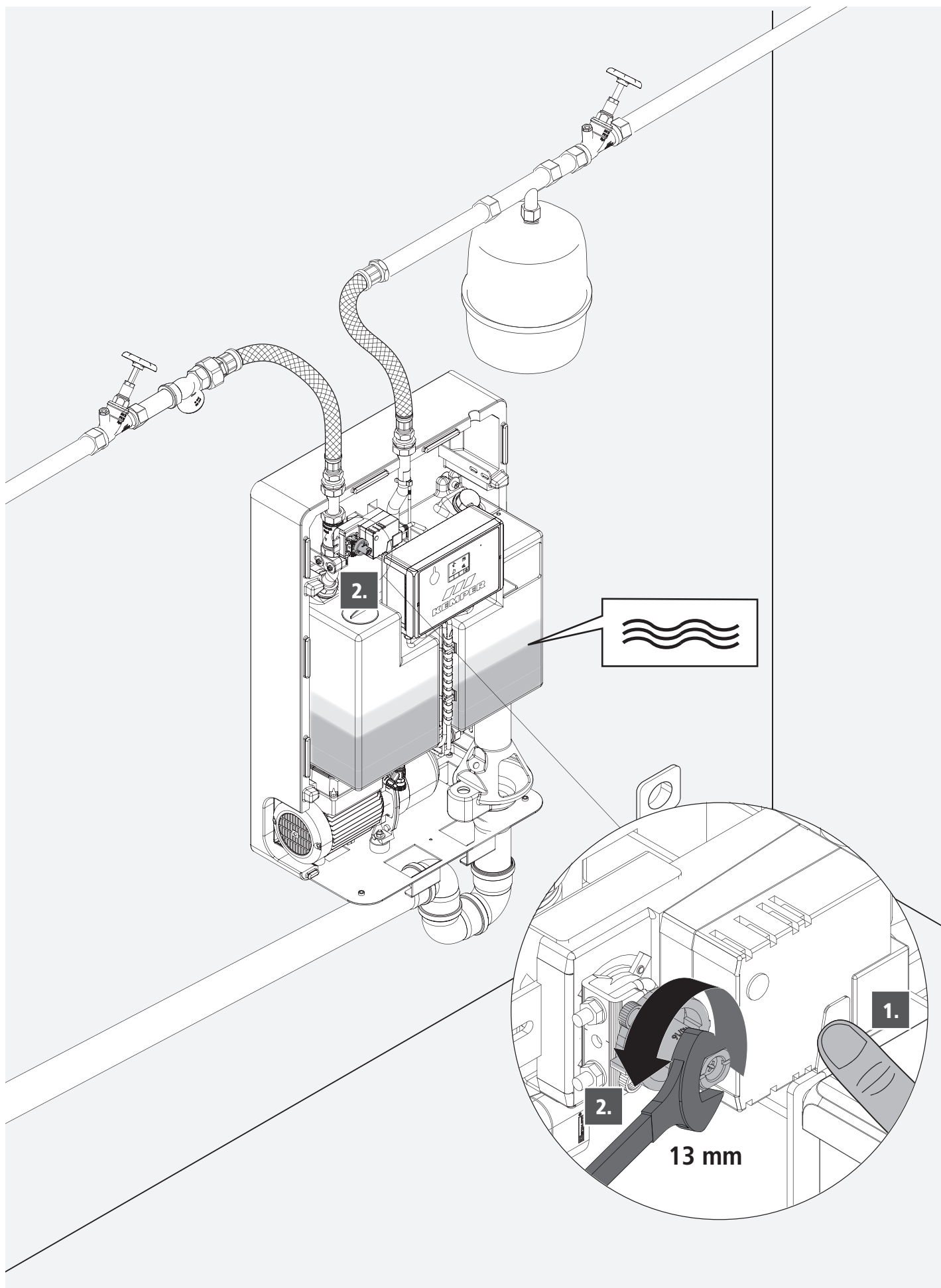
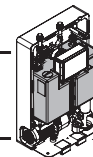

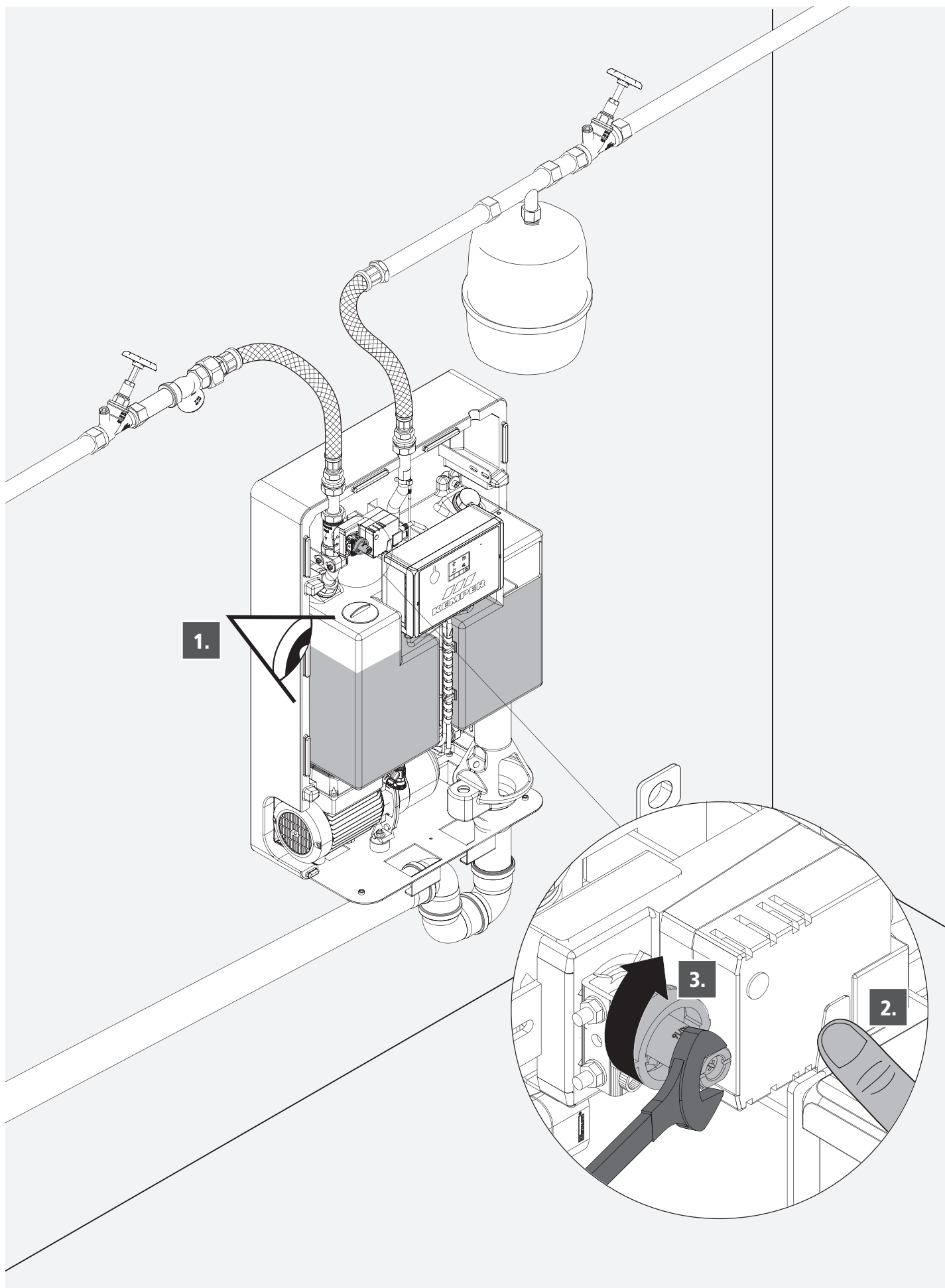
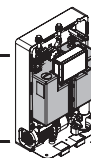

22

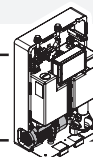
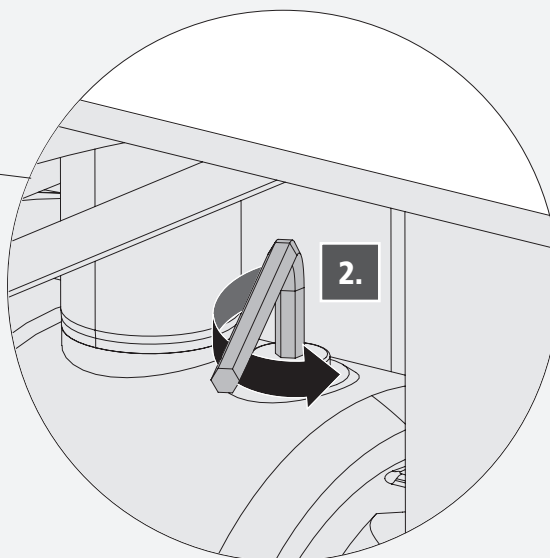
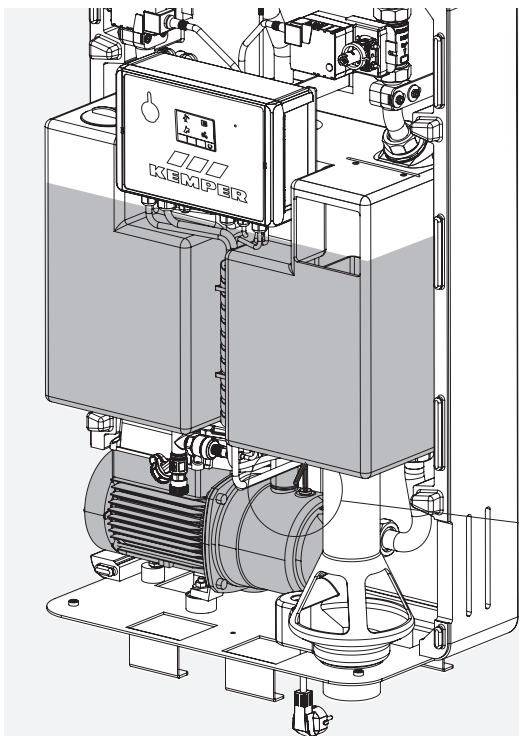
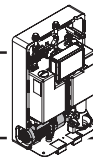

23

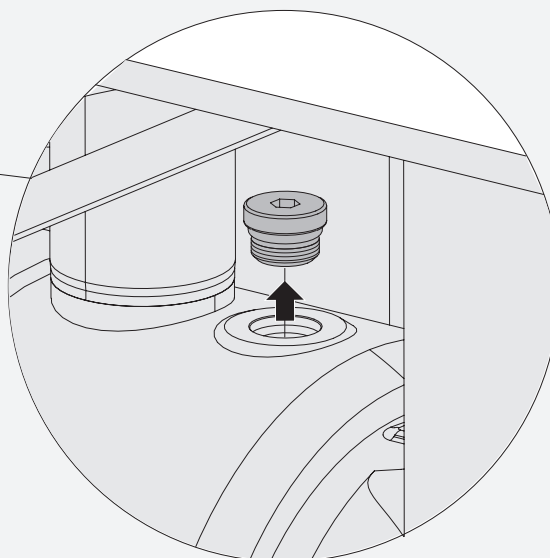
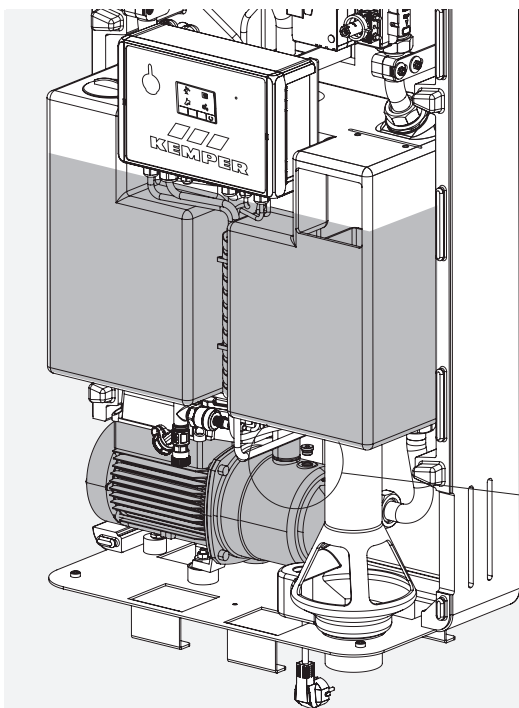

24

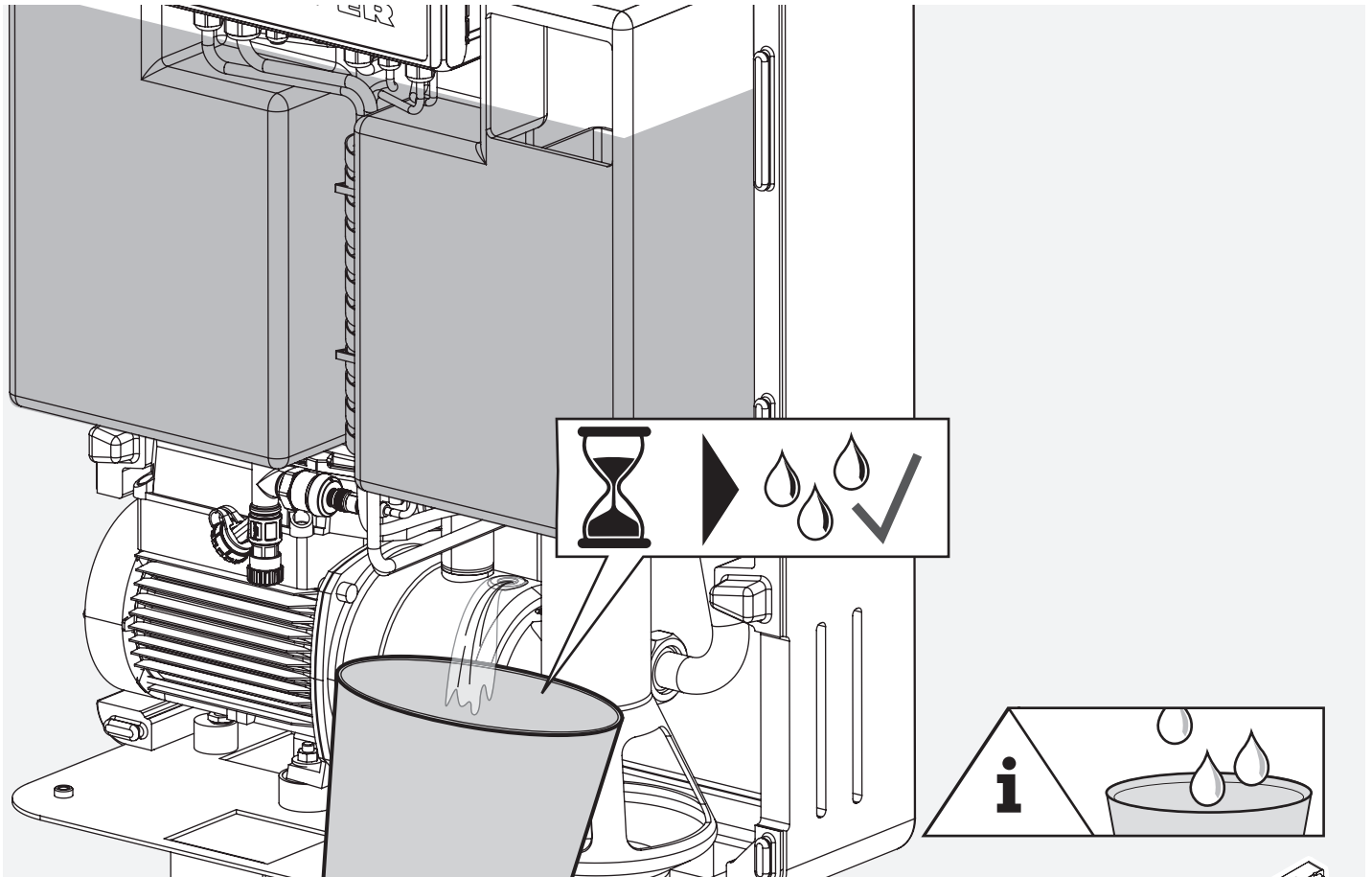
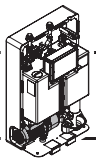

25

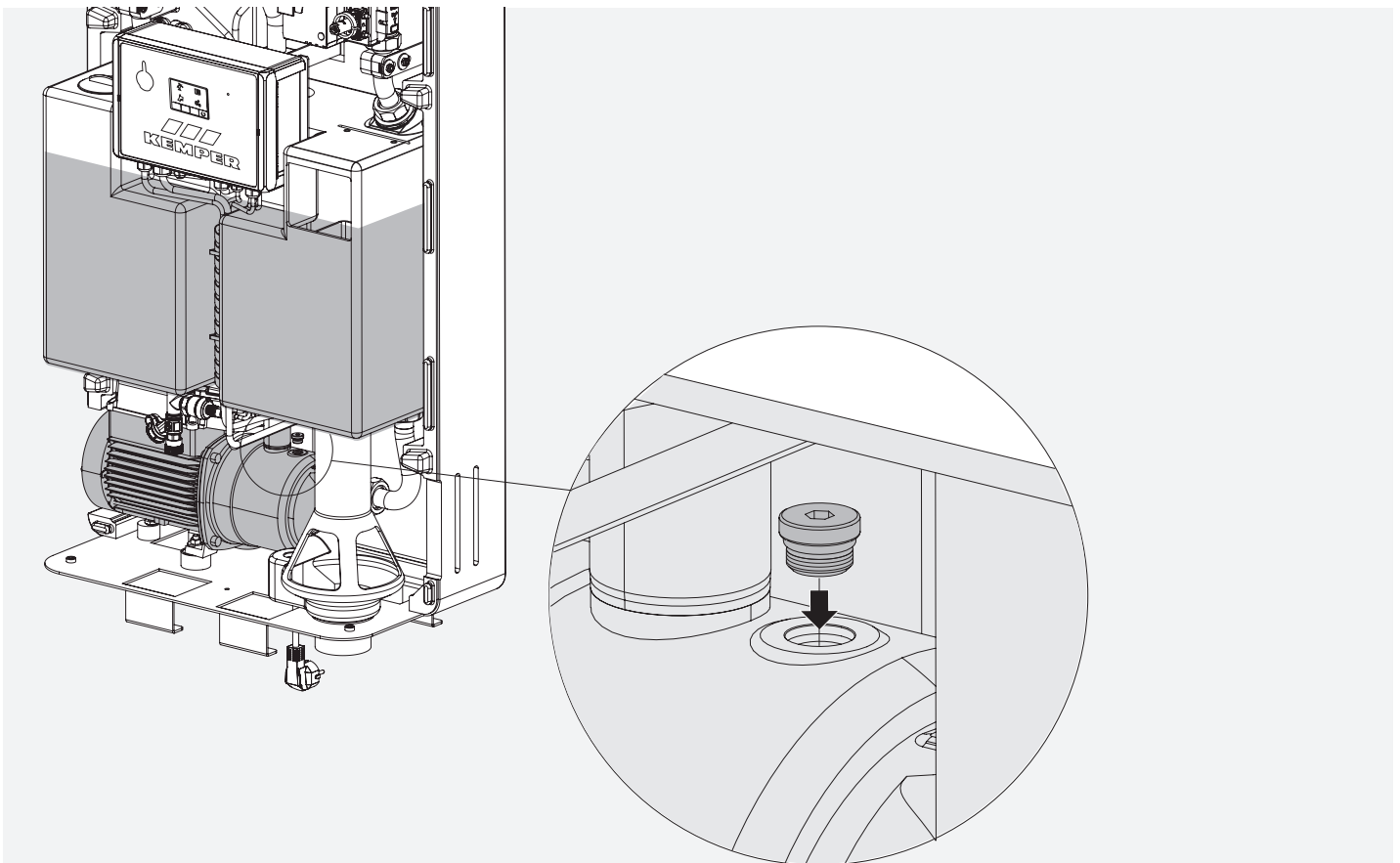
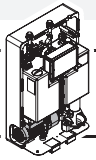

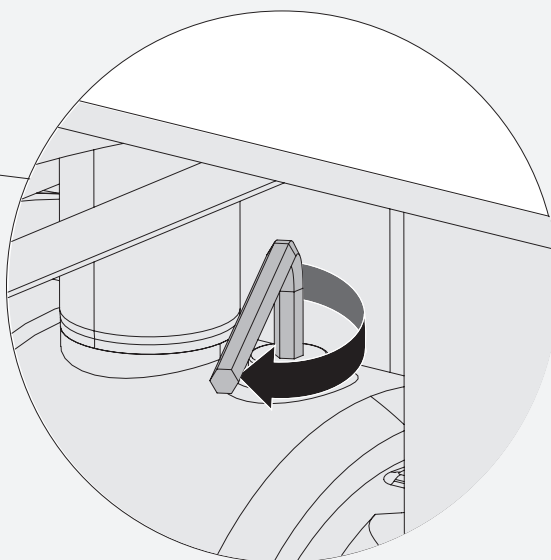
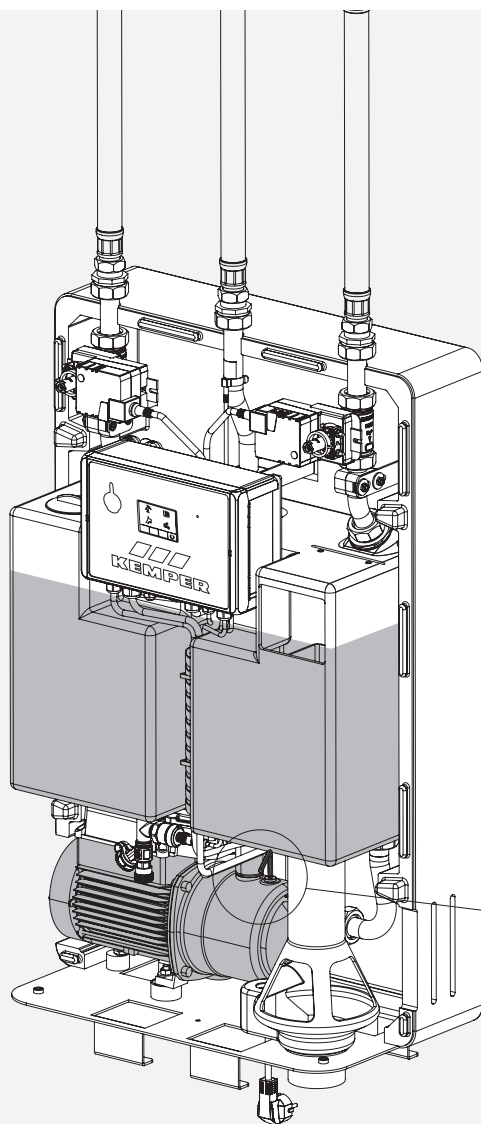
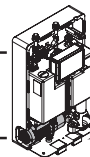

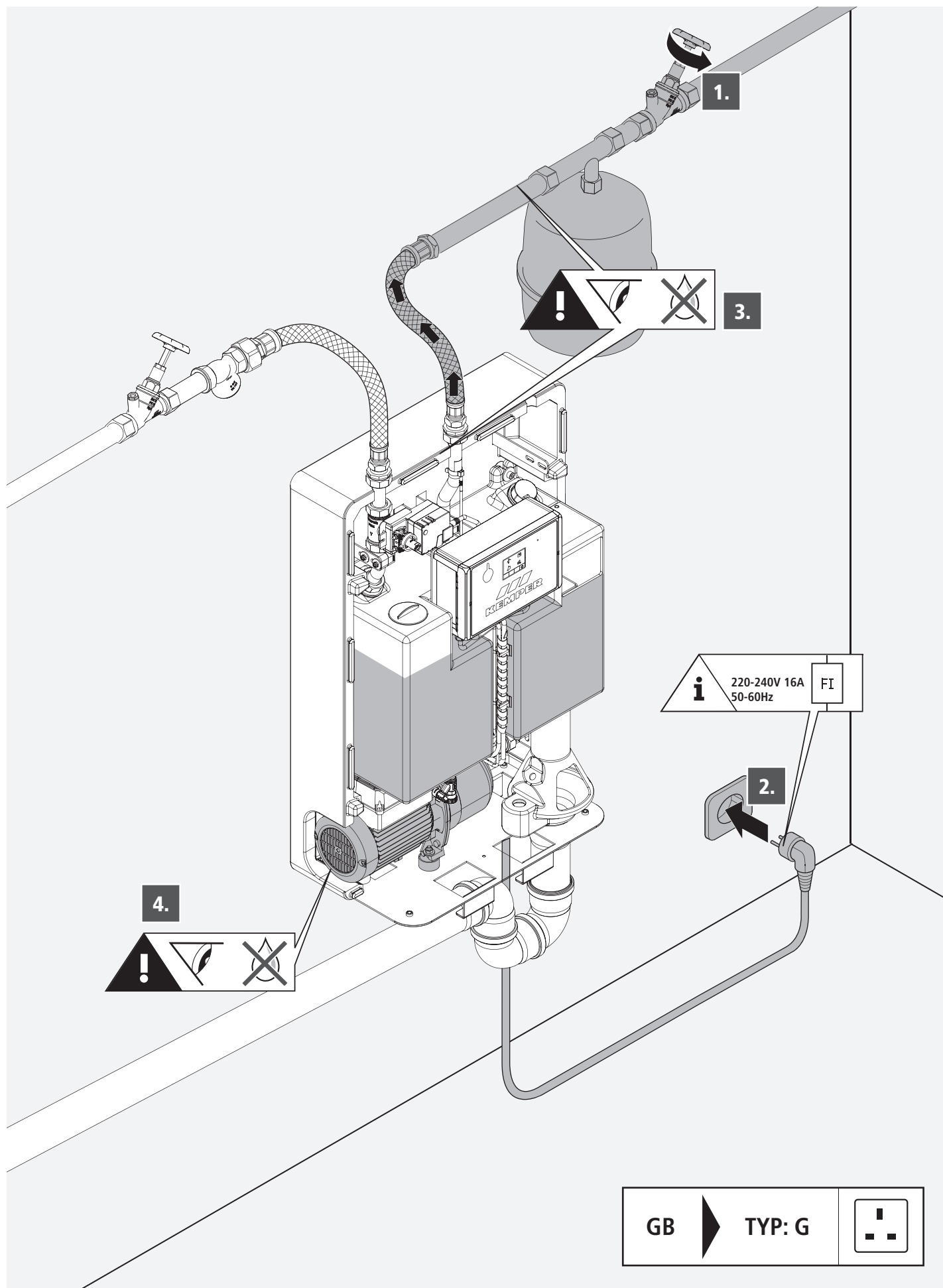
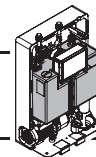

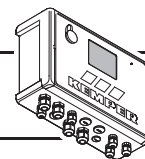

1



2

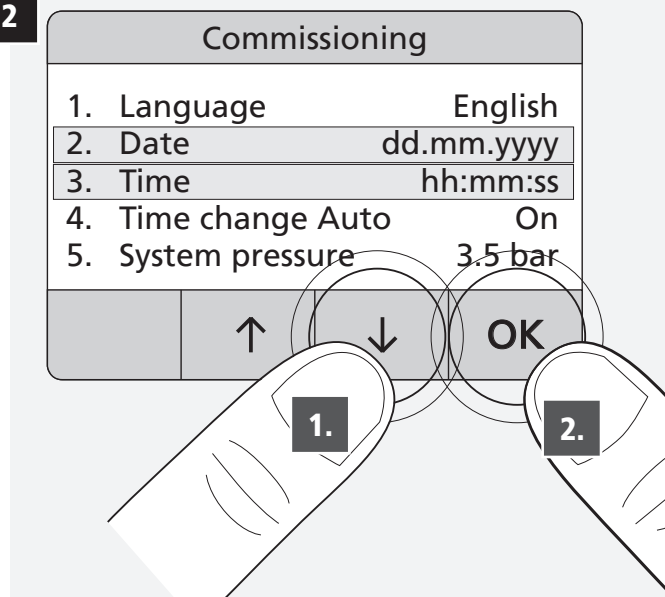

3

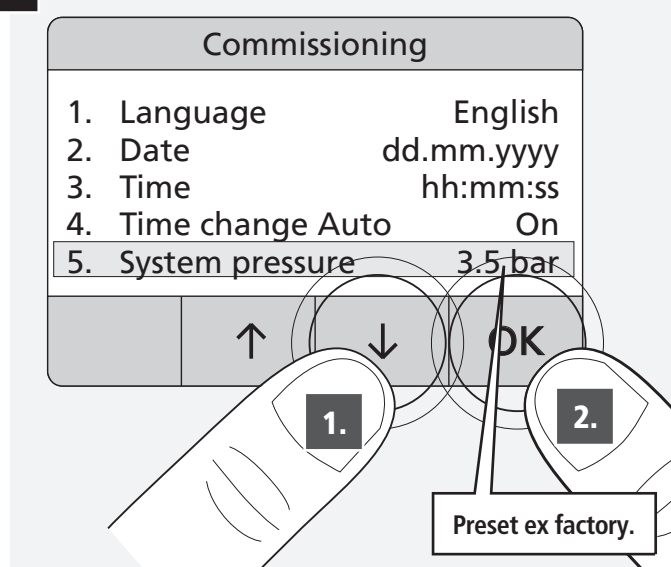

4

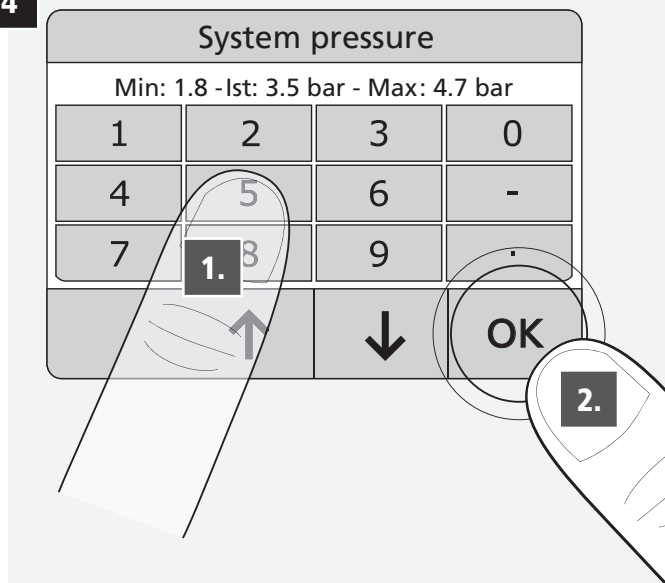

5

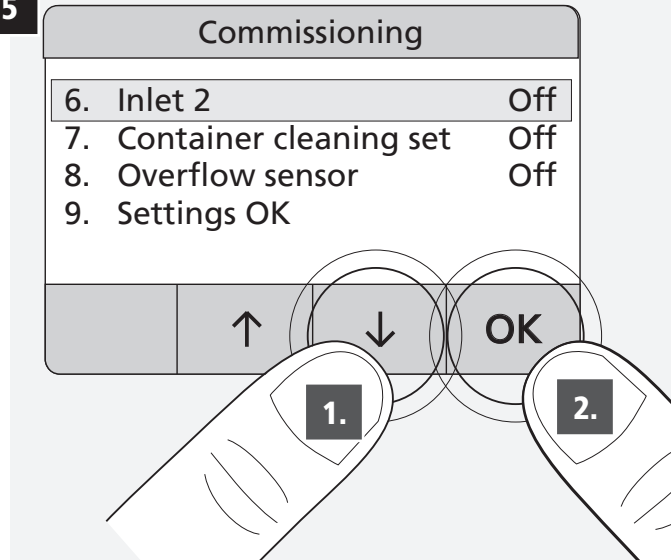

6

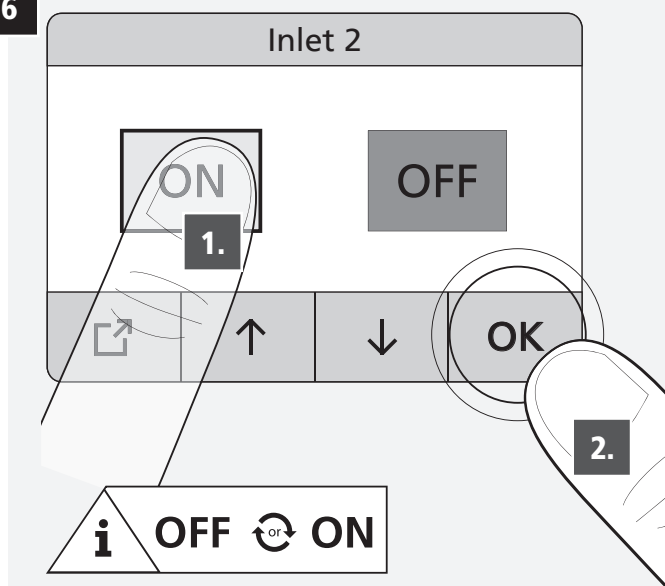

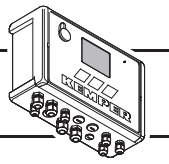

7

Commissioning	
6. Inlet 2	Off
7. Container cleaning set	Off
8. Overflow sensor	Off
9. Settings OK	

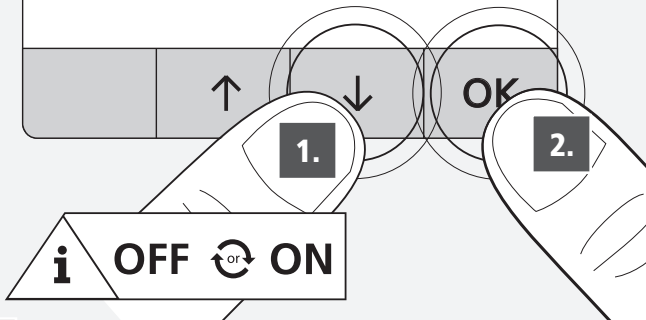

8

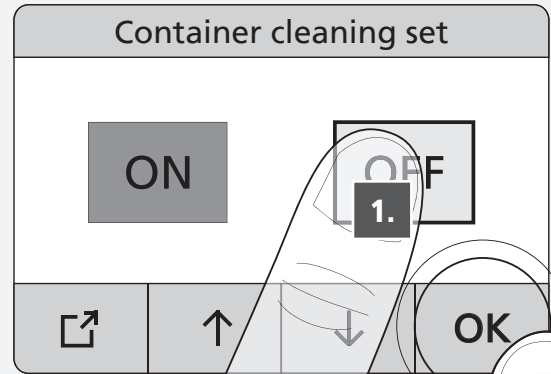

9

Commissioning	
6. Inlet 2	Off
7. Container cleaning set	Off
8. Overflow sensor	Off
9. Settings OK	

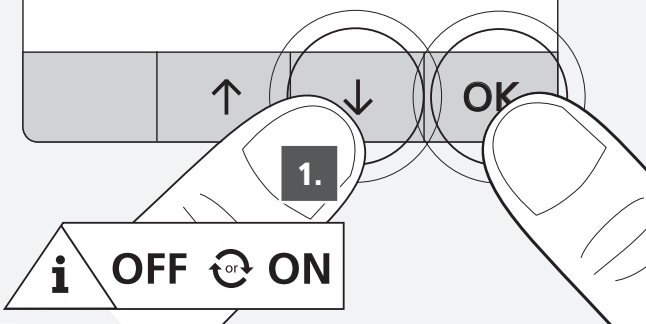

10

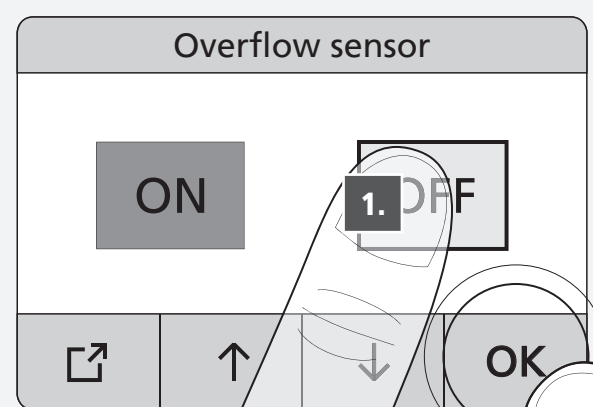

11

Commissioning	
6. Inlet 2	Off
7. Container cleaning set	Off
8. Overflow sensor	Off
9. Settings OK	

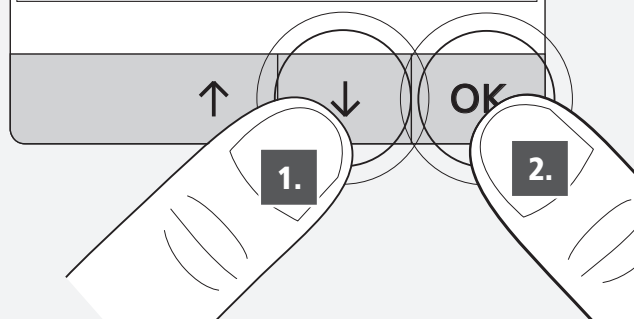

Note! The exact system setting is described in the operating instructions.

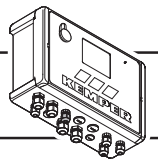

K410036930001-00

i**A**

EN Dosing signal
1 potential free normally open contact

i

max. 24 VDC
0,5 A | 12 VA

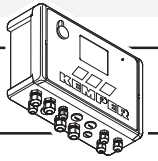
i**B**

EN Alarm output
1 potential free normally open contact

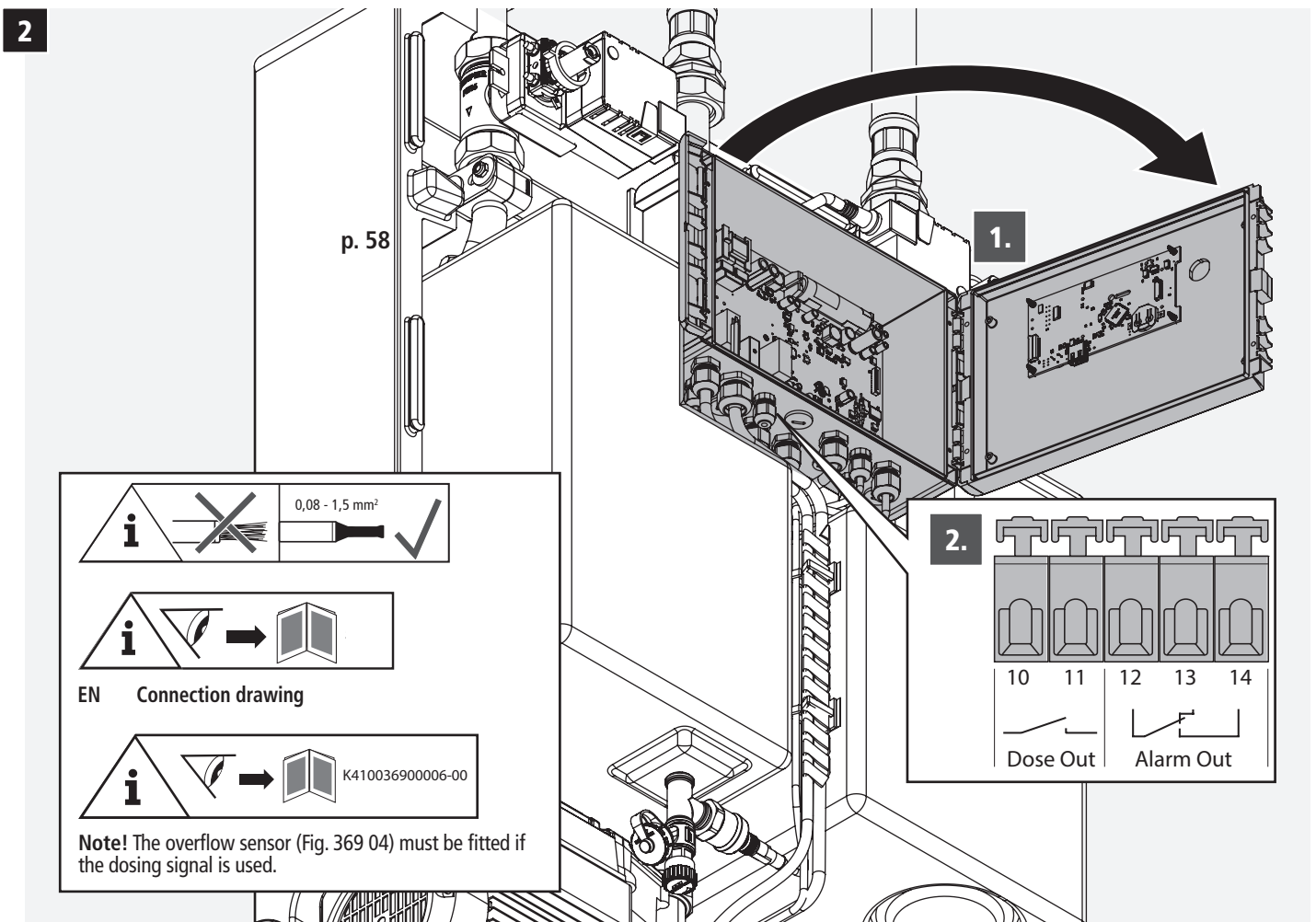
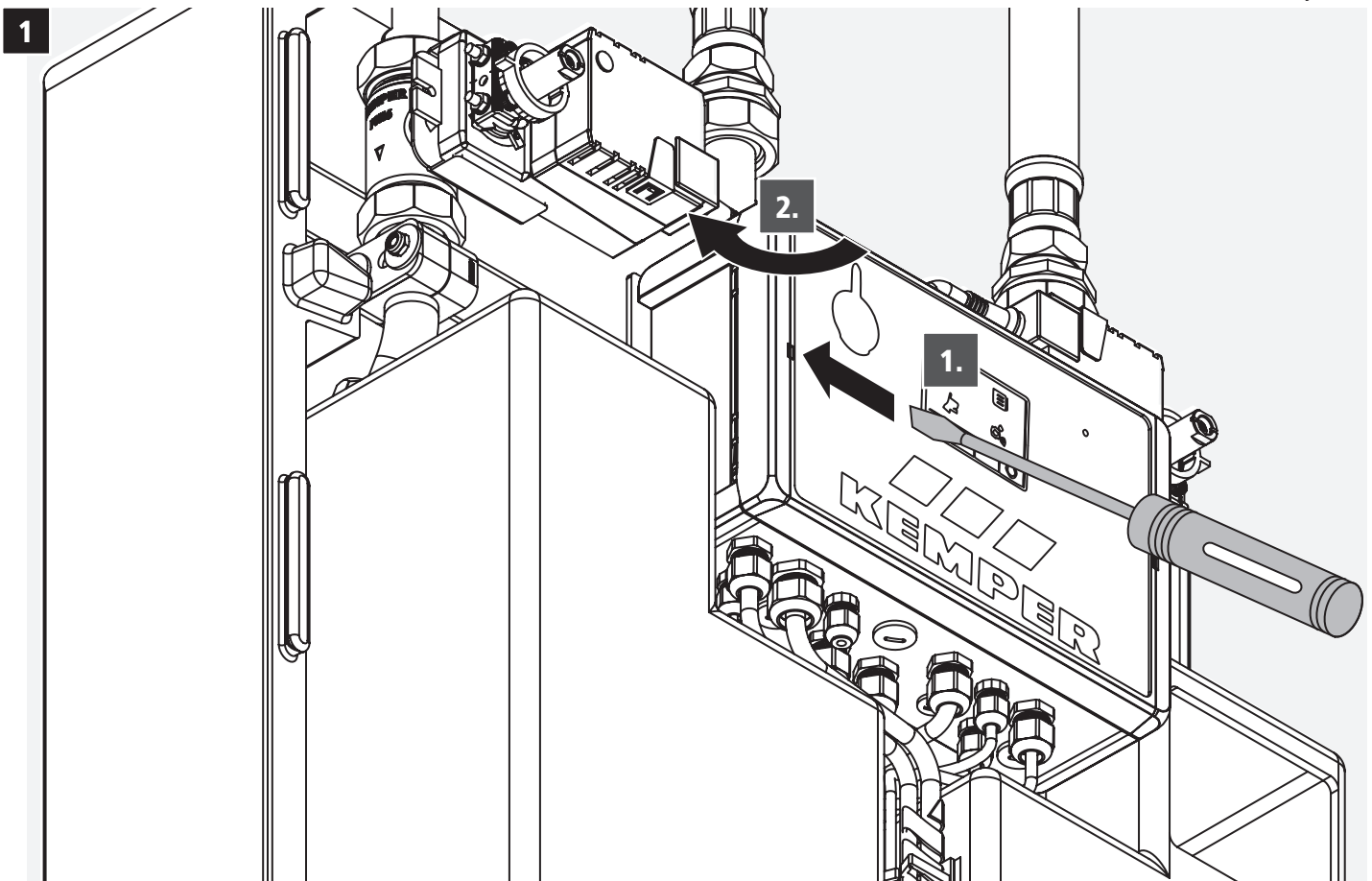

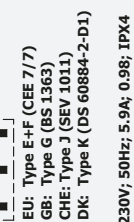



DIN EN 806-5

EN Maintenance

EN | Inspection and maintenance

Every six month maintenance according to DIN EN 806-5 shall be carried out.

The installed rechargeable battery shall be replaced at three year intervals. Controller warnings in this regard shall be treated with priority.

Every six month an inspection shall be carried out.

National or regional regulations shall be followed with priority.





