

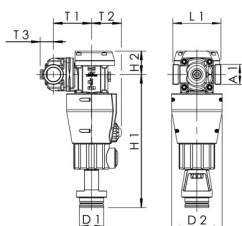

Product Features

- mechanically acting, manual backwash filter
- internal parts made of gunmetal, stainless steel and plastic
- with differential pressure controlled pollution indicator for maintenance
- opaque filter housing to prevent algae growth
- with manual backwash function for filter cleanup under operation
- can be retrofitted with optional pressure reducing valve cartridge DM
- expandable to a PRV-filter combination DMF by use of optional PRV cartridge DM
- male union thread
- exchangeable filter cartridge
- rotatable drain according to EN 1717
- free from dead spots
- for horizontal and vertical installation, drain valve down
- adjustable month indicator for next maintenance
- incl. allen key
- incl. gunmetal base module
- maintenance requirements in accordance with DIN EN 806-5 must be complied with



Standards and Approvals

- DVGW approval
- according to accepted materials list from German environmental agency
- up to DN 32 soundproofing certification according to DIN EN ISO 3822 Class 1
- DIN EN 1213 / EN 13443 / part no. 7120G13200 deviant to DIN EN 13443-1

Technical data

- pressure rating PN 16
- max. operating temperature 30 °C
- min. primary pressure 0.2 MPa
- lower mesh 90 µm
- upper mesh 125 µm

| Part no. | DN | A1 | D1 (mm) | D2 (mm) | H1 (mm) | H2 (mm) | L1 (mm) | T1 (mm) | T2 (mm) | T3 (mm) | flow at 0.02 MPa | flow at 0.05 MPa | Weight (kg) |
|------------|----|---------|---------|---------|---------|---------|---------|---------|---------|---------|------------------|------------------|-------------|
| 7120G01500 | 15 | G 3/4 | 50 | 105 | 276 | 48 | 90 | 79 | 62 | 21 | 2.4 | 4.1 | 3.51 |
| 7120G02000 | 20 | G 1 | 50 | 105 | 276 | 48 | 90 | 79 | 62 | 24 | 2.9 | 4.8 | 3.54 |
| 7120G02500 | 25 | G 1 1/4 | 50 | 105 | 276 | 48 | 100 | 79 | 62 | 28 | 3.1 | 5.1 | 3.59 |
| 7120G13200 | 32 | G 1 1/2 | 50 | 105 | 276 | 48 | 105 | 79 | 62 | 28 | 3.1 | 5.1 | 3.63 |
| 7120G03200 | 32 | G 1 1/2 | 50 | 145 | 384 | 87 | 105 | 94 | 62 | 30 | 7.9 | 12.3 | 6.62 |
| 7120G04000 | 40 | G 1 3/4 | 50 | 145 | 384 | 87 | 130 | 94 | 62 | 34 | 8.8 | 14.0 | 6.95 |
| 7120G05000 | 50 | G 2 3/8 | 50 | 145 | 384 | 87 | 140 | 94 | 62 | 39 | 9.4 | 15.4 | 7.37 |

Accessories

- gunmetal solder union connector, figure 476 04
- manometer with rear connection G 1/4, figure T5100 700 00 001
- manometer with below connection G 1/4, figure T5100 700 00 002
- gunmetal union connector, union nut, figure 476 06
- automatic backwash module for filter F and DMF, figure 712 99 004
- gunmetal union connector, union nut, FPT, with drain valve, figure 476 07
- gunmetal union connector, union nut, MPT, figure 476 08
- PRV cartridge, figure 710 00
- solder / pressfit union connector, figure 476 14
- pressfit union connector, MAPRESS stainless steel and copper, figure 476 22
- pressfit union connector, SANPRESS and PROFIPRESS, figure 476 30
- pressfit union connector, SANHA and NiroSan, figure 476 35
- pressfit union connector, MEPLA, figure 476 40
- pressfit union connector, MAPRESS stainless steel, figure 476 20
- pressfit union connector, SANPRESS INOX, figure 476 70

Spare parts

- basic module, figure 700 0G
- O-ring for basic module, figure 710 02
- PRV cartridge, figure 710 00
- filter cartridge, figure 713 00
- threaded plug , figure J8101 173 00