

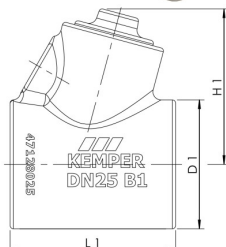

### Product Features

- suitable for MULTI T-PIECE figure 128 0G, KHS temperature sensor Pt1000 figure 628 0G and temperature sensor for KHS HS2 Hygiene Flush Box figure 689 00
- closed-cell foamed polyethylene, sound insulation
- simple installation using the insulation clips or diffusion-resistant lockable using standard adhesives



### Standards and Approvals

- to meet the requirements of GEG 2023
- building material class B1 according to DIN 4102
- CE marking

### Technical data

- min. operating temperature -40 °C
- max. operating temperature 90 °C

Part no.	for DN	D1 (mm)	H1 (mm)	L1 (mm)	Weight (kg)
4712801500	15	65	90.7	95	0.05
4712802000	20	70	94	98	0.05
4712802500	25	80	96.4	103	0.04
4712803200	32	90	103.7	108	0.05
4712804000	40	120	104.7	113	0.05
4712805000	50	140	114.4	127.5	0.09