

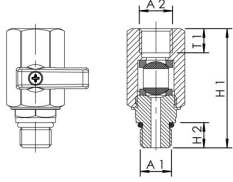

### Product Features

- to test the function of FK-4 RPZ backflow preventer using the differential pressure measurement set (figure 360 99)
- for connection to primary and reduced pressure zone
- for all dimensions



Part no.	A1	A2	H1 (mm)	H2 (mm)	T1 (mm)	Weight (kg)
3670700200	G 1/4	G 1/4	54	15	10	0.19

### Spare parts

- test valve for RPZ backflow preventer PROTECT, figure J7105 360 00