

Product Features

- to test the function of FK-4 RPZ backflow preventer using the differential pressure measurement set (figure 360 99)

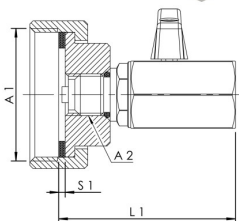

Part no.	for DN	A1	A2	L1 (mm)	S1 (mm)	Weight (kg)
3670601500	10-15	G 3/4	G 1/4	55	2	0.16
3670602000	20	G 1	G 1/4	55	2	0.19
3670602500	25	G 1 1/4	G 1/4	55	2	0.26
3670605000	50	G 2	G 1/4	55	2	0.40

Spare parts

- EPDM gasket for union connections, figure C3100 476 07
- test valve for RPZ backflow preventer PROTECT, figure J7105 360 00